

Tegometall

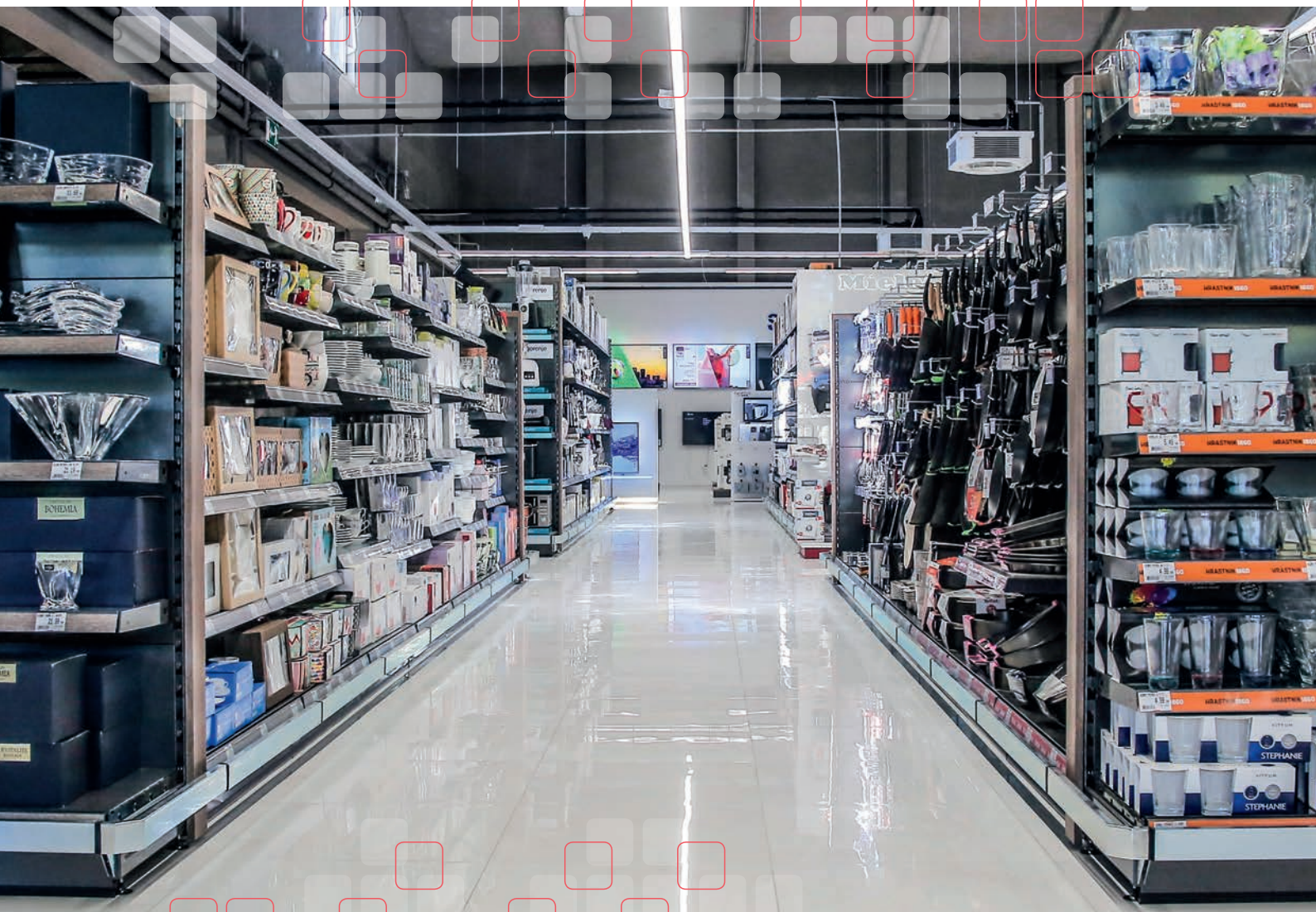

CATALOGUE 2020

Globally present. Locally anchored.



Head office in Lengwil (CH, central management, sales)
Krauchenwies factory (DE, shopfitting, logistics centre)
Sauldorf factory (DE, storage technology, coil slitting)

Lengwil factory (CH, production)
Šentjur factory (SI, production, sales)
Pniewy factory (PL, production, sales)



Nottinghamshire office (GB, logistics, sales)
Forbach office (FR, logistics, sales)

Service Center
(AT, BE, CH, CZ, DE, EE, FR, GB, GR, HU, IL,
IT, LV, MK, NL, NO, PL, RO, RS, SI)

The Tegometall Group – welcome to the world of shelving

Dear Customers

Dear Business Partners

The last few years have been significant years for us. We have looked back on half a century of the Tegometall success story and set the course for the future. In the beginning was the vision of our company founder Rudolf Bohnacker, to help every retail customer to succeed with a sophisticated modular system for shop fitting and warehouse racking. Accordingly, we have grown from a small business to a globally operating company, the Tegometall Group. With around 800 employees we process in excess of 100,000 tonnes of steel per year and export to more than 100 countries worldwide.

The five main production sites in Europe are characterised by economical and highly automated production. Through the use of innovative technologies and permanent process development, we guarantee a consistent high quality, short delivery times and cost-effective products. The five European sales locations and the new logistics centre in Southern Germany ensure our proximity to customers in the respective markets, for both nationally and internationally operating customers.

Our logistics centre in Krauchenwies and our decentralised warehouses in the international sales branches enable us to make fast deliveries of the price-optimised core range and to process large rollouts on schedule.

«With our economical and highly automated production, our core objectives are therefore not contradictory to us, but instead have become our main focus. In summary, we are the reliable partner for economical shop fitting and warehouse racking solutions.»

In order to be able to meet special customer requirements and supply integrated markets from a single source, we have strengthened our organisation with a foothold for special solutions in Slovenia. This is where innovative solutions, from the development to the finished product are produced, according to customer-specific requirements for rollouts or entire markets. To ensure that our proven principles are adhered to, the basis for our products and solutions continues to be the reliable and flexible modular principle, which offers our customers an effective and combinable shop fitting or warehouse racking system.

For decades, economic efficiency has been an integral part of our corporate culture and production. Our striving for continuous improvement and our aim to develop the perfect solution for every customer has always driven our company. We are enthusiastically developing new technologies and processes to ensure that our shelving and racking systems continue to be up-to-date in the future.

«Modularity, economy and durability makes Tegometall the effective and sustainable original.»

Through a motivating environment and cooperation based on trust, we have taken several steps forward in just a short time and can quickly respond to the market with new logistical processes and products. We continue to actively promote this positive development to be able to respond quickly and in a solution-oriented manner, to the wishes and needs of our customers in the future.

We thank our employees for their commitment, their passion and creativity. With their dedication and motivation, they are the foundation for our successful development in recent years. A special “thank you” goes out to our customers and business partners for their longstanding and trusting cooperation with our company.



Tegometall Management from l.: Dr. Arndt Lüdtkke (Manager); Ulrich Bohnacker (Owner); Jakob Bohnacker (Owner)

Strong past. Strong future.

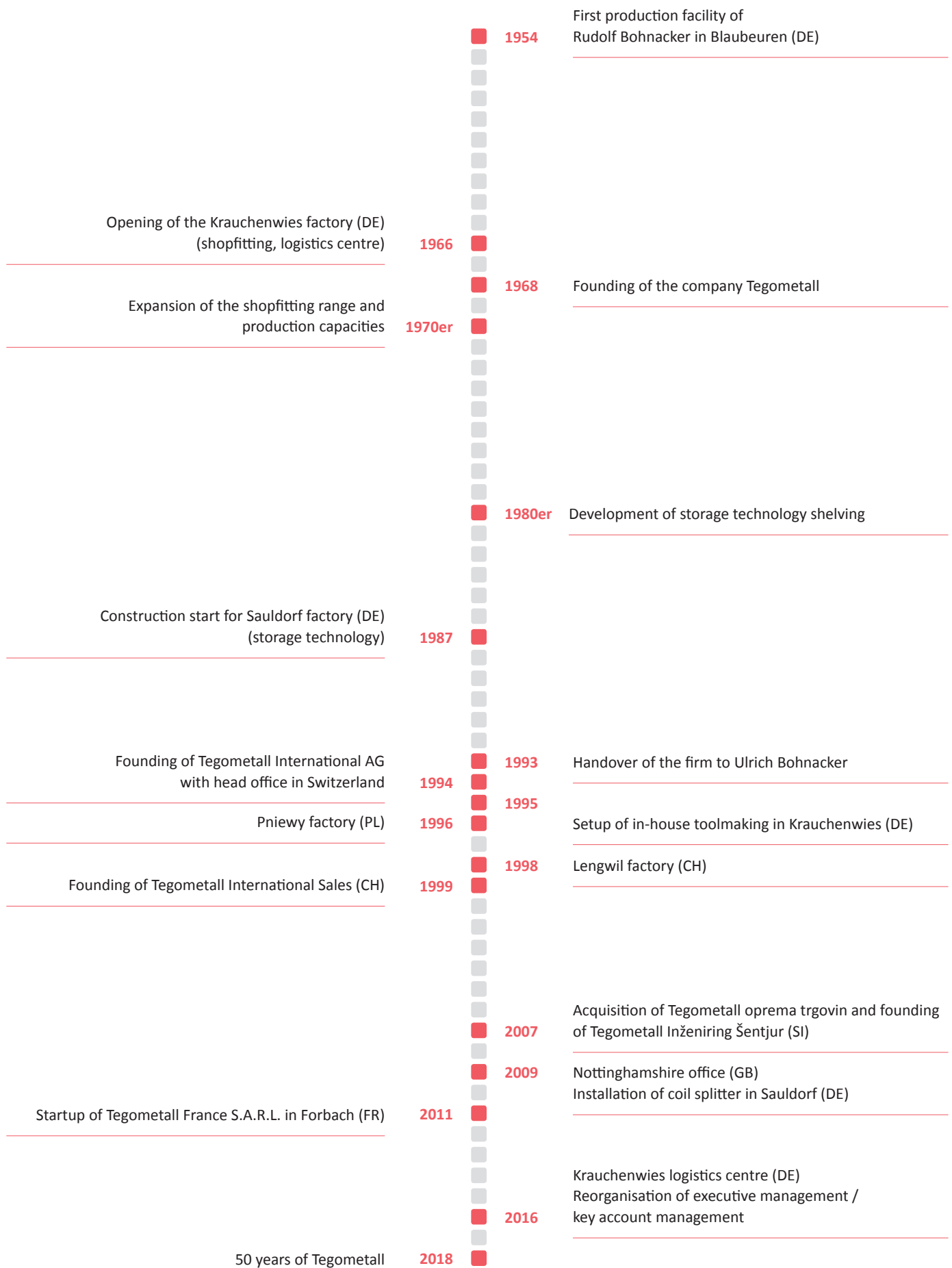

Facts & Figures

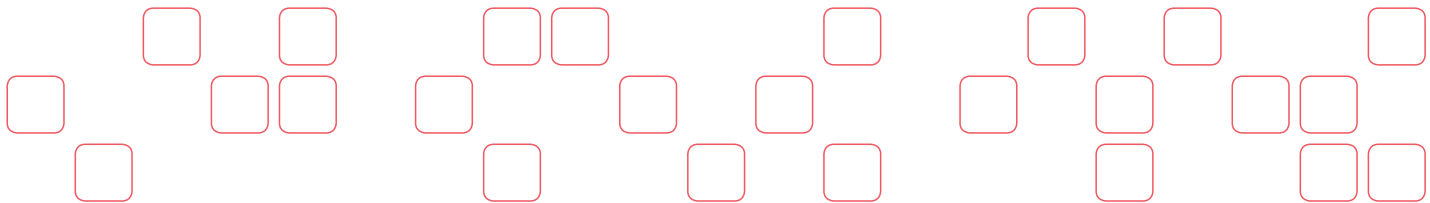
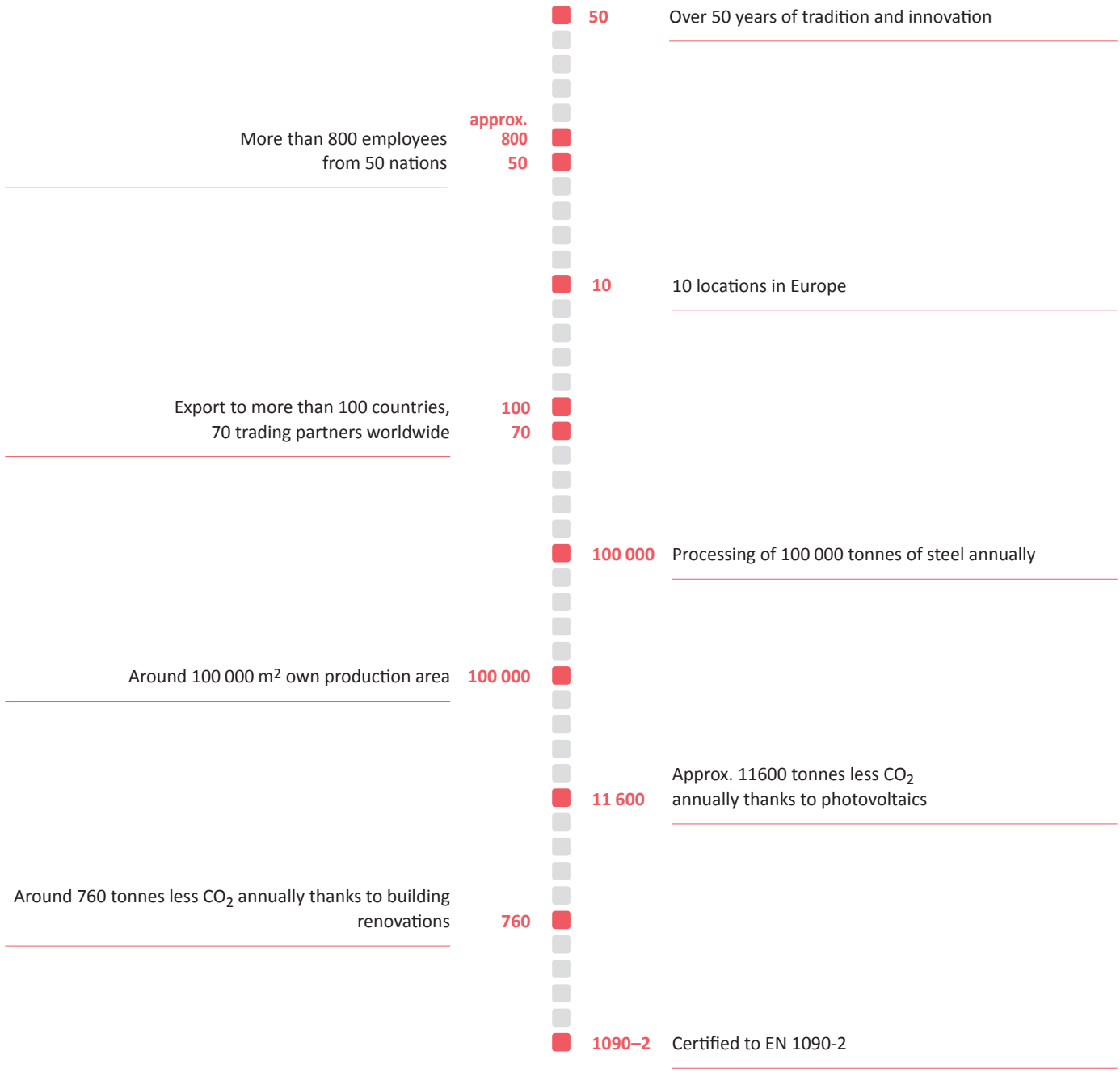

What can you bank on? Reliability

Success requires investment. We have been investing in new planning tools, digital controls and continuous training of people at Tegometall for years. The combination of expertise and technology makes us effective – always with the focus on reliability for you as our customer. Plan and build your projects the way you want: our structured processes in planning, production and delivery provide you with support.

In direct cooperation and continuous communication with each other, you will receive Tegometall products and services promptly and in the usual, reliable high quality. The focus on every detail makes us credible.

Trust in these values –
and your construction
project will be a success.

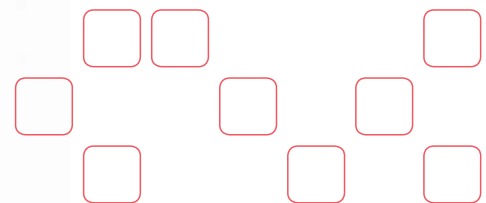

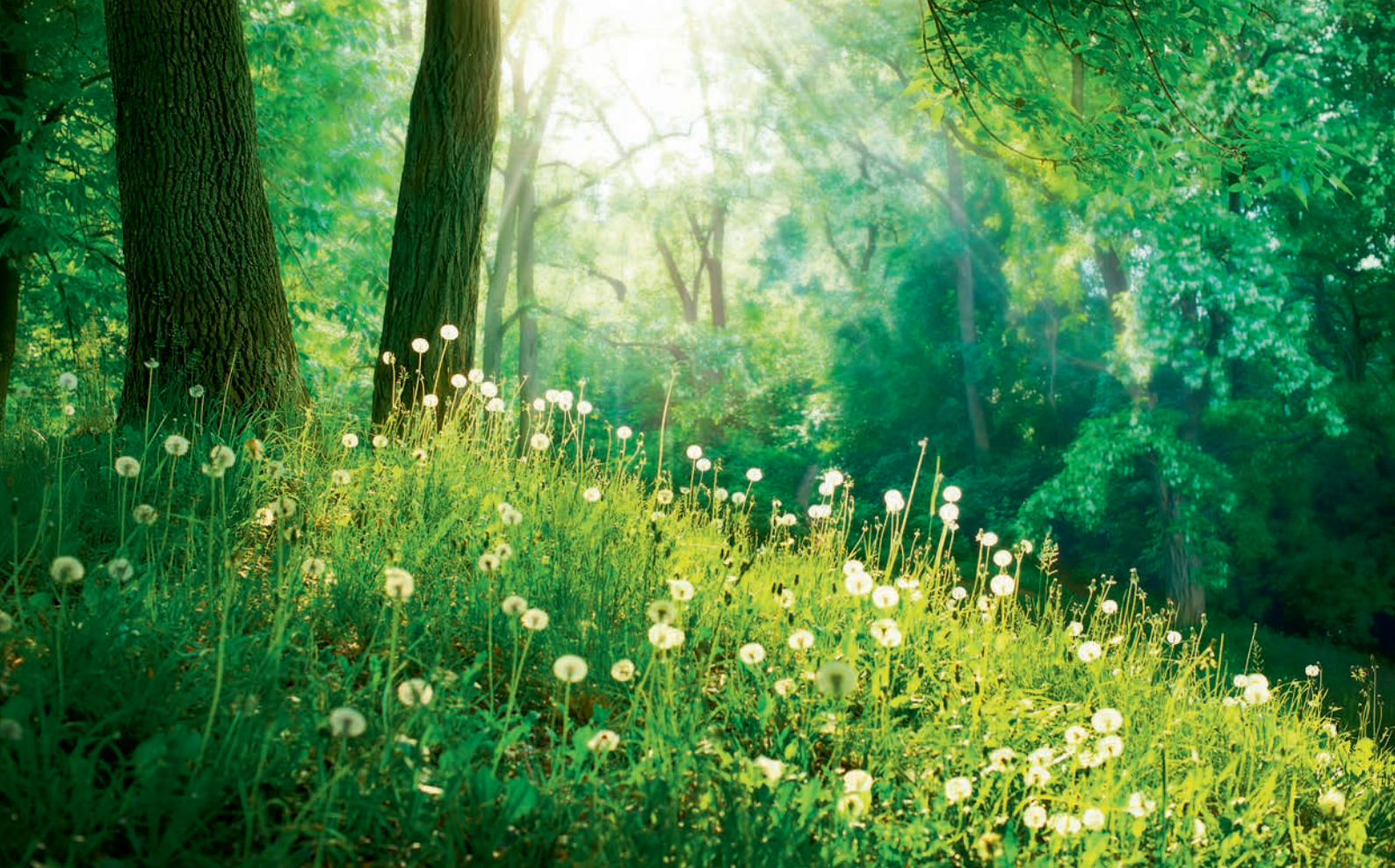

Ecology needs economy

The environment is a priority of ours. We are motivated to actively protect the environment: all Tegometall Group locations are therefore equipped with state-of-the-art production facilities. This underlines the ecological value of efficient energy use in all areas.

Profitability is always part of sustainability. In order to meet the growing demands of the product range, customer interests and new trends, we need cutting-edge technology. Large-scale production of our products requires up-to-date industry standards – always with a focus on Tegometall quality and saving resources.

We have been successfully pursuing our goals in these areas for many years:

Reduction:

Of water, electricity, packaging and raw materials

Energy efficiency:

Transport by rail whenever possible

Solvent-free:

Painting operations with modern powder paints

Wastewater-free:

Surface coating without water contamination

PVC-free:

No films in production or storage

Thanks to our many years of experience in all areas of shop fitting and storage technology, we also guarantee sustainability – for the environment, and for your long-term market success.

NEW at Tegometall: project planning from A to Z

Advice

The focus is on your desire for a construction project that achieves the set goals without unwanted surprises. Through holistic project development and as an experienced hardware producer, we are familiar with the success factors of planning projects in your industry: we advise you and work together with you to identify needs, knowledge of market requirements, integration of strategy specifications and legal restrictions. We can start together here!



Idea and project development

The analysis is followed by the focus on the desired project at your sales or storage location. During the project development phase, we will collate the prepared basics. Now we put together your individual building project – whether a new construction or reconstruction. The combination of our standard products and the tailor-made parts we produce allows for new approaches to solutions.

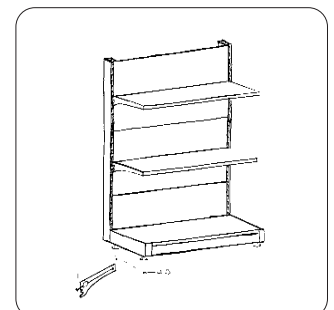
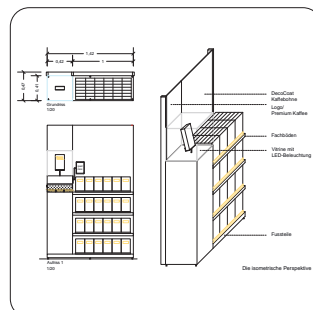
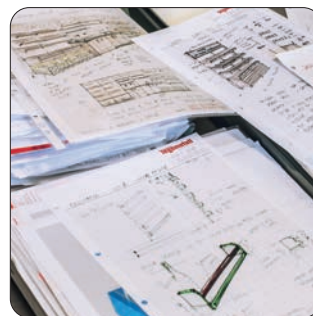

Planning and production

When projects become reality, our planning specialists are virtually live in your future sales or storage facilities. We accompany all steps efficiently with the latest software. Step by step, each idea is now professionally compiled for production and assembly by our experts. Thanks to our versatile experience we offer you the optimum with our modular system for shop fitting and storage shelves.

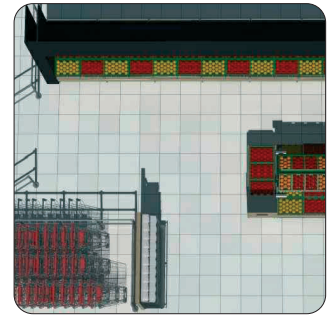
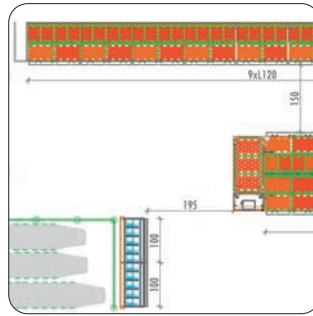

Implementation

Production in our company is subject to the great demand for sustainability and environmental protection. We provide your plants for you just-in-time. To ensure that every single product arrives at your site as planned, the Tegometall team takes care of the assembly on-site until final acceptance. At the point of sale, our extensive experience in storage and retail trade in all size ranges is an advantage for you. We wish you all the best in business!



Brilliant decors. Food safe.

Design rooms with colours and decors and add accentuation

Realise your ideas and visions with **DecoCoat**.

Simply feel good

Design your shop fitout, individually and creatively. Have back panels, shelves or uprights printed with your own motifs and designs. Or choose a decor from our numerous special colours, as well as wood, stone and metal patterns.

Create a recognition factor for your customers and an atmosphere to feel good in.



Simply brilliant

With the brilliant colours of our DecoCoat products, you make every area of use shine. Our DecoCoat coatings are also food safe and free from harmful binders and solvents. Our products can therefore be used in the food industry without hesitation.

Present your food with our DecoCoat shop fitouts.

Simply sustainable

Our special sublimation process for applying the DecoCoat coating enables the production of environmentally friendly shelving with Tegometall high quality. The very hard-wearing surface can be treated with all solvent-free cleaning products. Enjoy all the advantages of our shop fitout and at the same time create an individual atmosphere.



Safe? Sure!

Shelving systems with DecoCoat coatings can be safely used for the storage of food. Even the storage of moist and greasy foods directly on the DecoCoat coating was classified as safe. A certificate (clearance certificate) confirming the safe use of DecoCoat coatings in the food sector is available.

Standard Colours & Special Colours

We see in colours, think in colours, feel in colours.

Colours and their symbolism are tightly weaved with everyday life and the respective cultural history. Colours affect our emotional life and cause specific associations.

For companies and clubs, certain colours or colour combinations serve as identification features.

Coloured lettering or colour logos are icons which guarantee that an unmistakeable impression is left behind. We have a conscious or unconscious opinion on every colour.

Use of colours can pay.

Colour can:

- increase the recognition value of a brand by 80 percent.
- increase clearness and readability by 73 percent.
- coloured advertising is noticed 42 percent more frequently than comparable advertising in black & white.

So make something special of your shop fitout, distinguish yourself from the rank and file and in doing so ensure that your customers like to come again.

We have innumerable colours and special colours to choose from in our range and will be pleased to advise you!

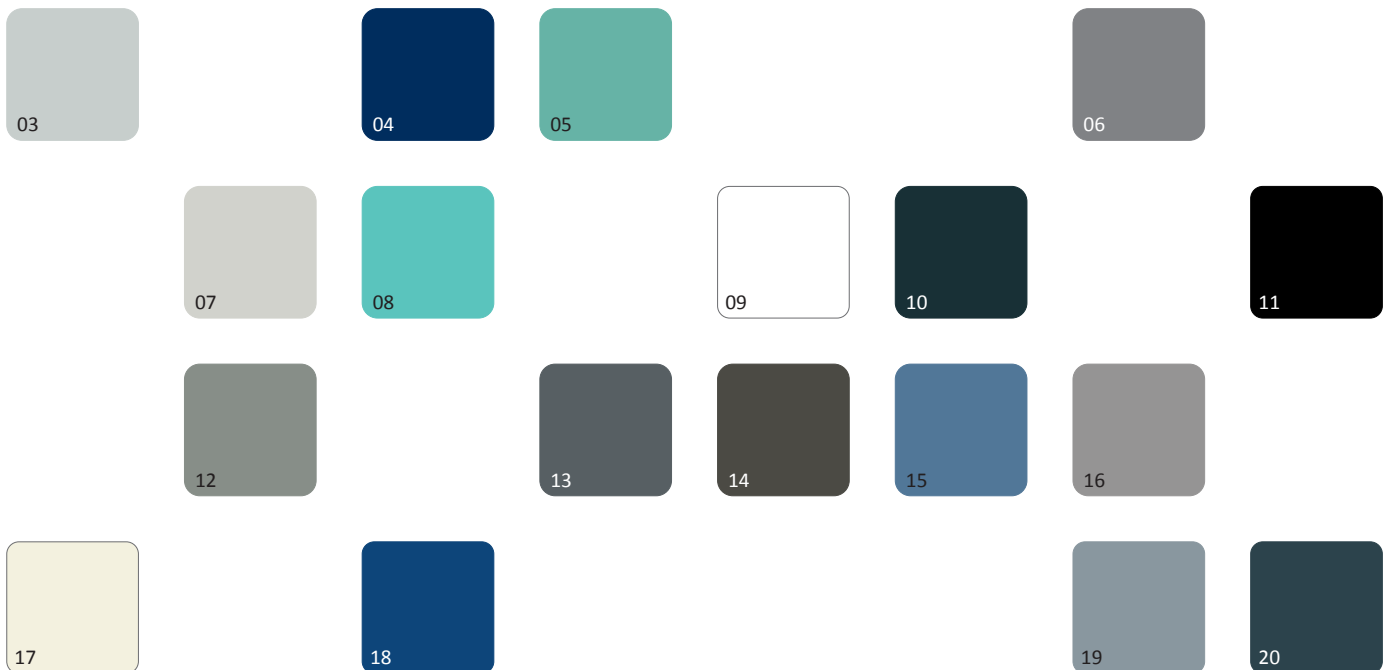

- | | | | |
|-----------------------------|-----------------------------|--|------------------------------------|
| 1 RAL 9006 White aluminium | 6 RAL 9007 Grey aluminium | 11 RAL 9005 Jet black | 15 RAL 5014 Pigeon blue |
| 2 RAL 6019 Pastel green | 7 RAL 7047 Telegrey 4 | 12 RAL 7030 Stone grey | 16 RAL 7036 Platinum grey |
| 3 RAL 7035 Light grey | 8 RAL 6027 Light green | 13 Based on RAL 9023 Pearl dark grey metallic | 17 Jura white, similar to RAL 9001 |
| 4 RAL 5013 Cobalt blue | 9 Plastic white | 14 Based on RAL 7048 Pearl mouse grey metallic | 18 RAL 5010 Gentian blue |
| 5 RAL 6034 Pastel turquoise | 10 RAL 7016 Anthracite grey | | 19 RAL 7001 Silver grey |
| | | | 20 RAL 7015 Slate grey |

Many other special colours are available on request.

List of Abbreviations Used

General abbreviations:

■	GL	–	smooth
■	RL	–	Round holes
■	SB	–	Self-service
■	SL	–	Combined round and key holes
■	VE	–	Packaging unit
■	◆	–	Reference: see page

Dimensions and units:

■	B	–	Width
■	H	–	Height
■	L	–	Length
■	T	–	Depth
■	∅	–	Diameter
■	cm	–	Centimetre
■	kg	–	Kilogram
■	m	–	Metre
■	mm	–	Millimetre

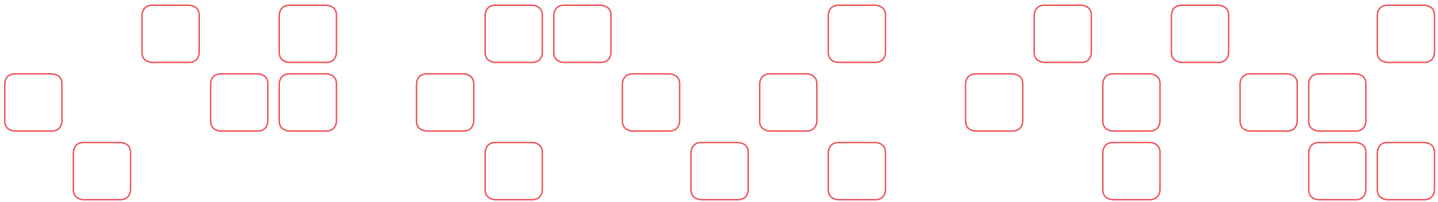

Imprint

Tegometall

Tegometall International Sales GmbH
Industriestrasse 7
8574 Lengwil
Switzerland

Telephone +41 (0)71 686 93 00

info@tegometall-sales.com
www.tegometall.com

Please order from a Tegometall ServiceCenter near you.

Drawings and illustrations are without commitment. All rights reserved.
All prices are prices recommended by the manufacturer. VAT and possible
customs charges for specific countries, or import taxes and transport are not
included.

Our current General Terms of Sale, Delivery and Payment apply with the
respective addition.

Note: Our prices do not include assembly.

Colour differences are possible. We reserve the right to make technical
changes without notice in the interests of continued development.

Our previous catalogues and components price lists are hereby cancelled.

Essential components of our product range are legally protected in Germany
and abroad.

Copyright © 2020
Tegometall International Sales GmbH (hereafter called Tegometall)
All rights reserved.

All illustrations are the property of Tegometall. All illustrations and descrip-
tions, including all trademarks and symbols, are protected by copyright and
other industrial property right laws. Any reproduction, distribution or publi-
cation, including on the internet or any other use, is prohibited. The content
may not be reproduced, passed on and/or used without the prior written
consent of Tegometall.

Contents

Introduction

The Tegometall Group – welcome to the world of shelving	1
Strong past. Strong future	2
Facts & Figures	3
What can you bank on? Reliability	4
Ecology needs economy	5
NEW at Tegometall: project planning from A to Z	6
Brilliant decors. Food safe	8
Standard Colours & Special Colours	9
List of Abbreviations Used	10
Imprint	10

TegoClassic

TegoClassic components overview	13
Gondola with shelves and back panels	13
Wall shelf with slat panels and rear support bars.....	13
Wall shelf with subdivided shelves.....	14
Subdivided shelf.....	14
Wall shelf with back panel SL, back panel RL and various hooks	15
Wall shelf with wire articles.....	15
Fascia.....	16
TegoClassic Technical Information	17
Colour and finish code / Order information.....	17
System sizes	18
Permissible loads	19
Internal corners	22
External corners.....	23
1 Uprights and Wall-mount Uprights	25
Wall-mount uprights with H-slots	25
Accessories for uprights	26
2 Baselegs and Brackets	31
Baselegs	31
Plinthes	32
Accessories for baselegs.....	33
Shelf brackets.....	33
Accessories for shelf brackets	35
3 Back Panels and Hooks	36
Back panels GL.....	36
Back panels SL.....	37
Back panels RL	37
Supplements for back panels	38
Accessories for wooden parts	39
Hooks and special holders	40
Slatted back panel walls	43
Hooks for slatted back panel walls.....	43
4 Shelves and Accessories	45
Shelves	45
Accessories for shelves.....	46
Scanning ticket strips.....	49
Scanning frame	50

5 Special Parts	51
Fascias and accessories	51
Perforated rear support bar 50x20 mm.....	52
Holders for perforated rear support bar	52
Special parts for textiles	54
Gondola end frame.....	54

6 Wire Articles	55
Wire articles and accessories	55

TegoTwo-in-One

TegoTwo-in-One Components Overview	58
TegoTwo-in-One without SB integration	58
TegoTwo-in-One with SB integration.....	59
TegoTwo-in-One Technical Information	60
Colour and finish code / Order information.....	60
System sizes / Stand sizes / Chipboard sizes	61
Chipboard dimensions /Number of elements and load capacity for shelving elements and perforated shelves.....	62
Permissible loads	63
Example calculations of the permissible bay and compartment loads, TegoTwo-in-One – System CG 55x40.....	66
Example calculations of the permissible bay and compartment loads, TegoTwo-in-One – System CG 70x80.....	67

A Stands	69
Stands for TegoTwo-in-One, screwed type.....	69

B Traverses	73
Traverses for TegoTwo-in-One	73

C Depth Connectors and Shelving Elements	78
Depth connectors	78
Shelving elements.....	79

D Accessories and Safeguard Parts	81
Accessories for TegoTwo-in-One	81
Safety accessories for TegoTwo-in-One.....	82

E Parts for Integration	85
Parts for integration for TegoTwo-in-One	85

Indexes

TegoClassic Index	86
TegoTwo-in-One Index	87

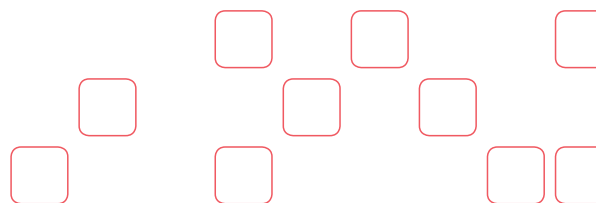

TegoClassic



TegoClassic components overview

Gondola with shelves and back panels

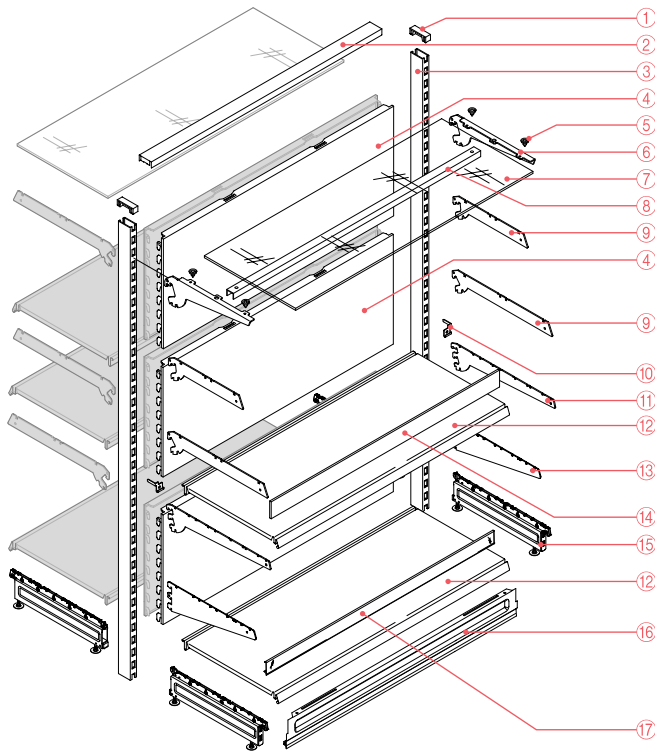

Z4286

①	Top caps for uprights	▶ 28
②	Gondola cover strip	▶ 38
③	Upright	▶ 25, 26
④	Back panel	▶ 36
⑤	Glass supports for angular shelf brackets	▶ 35
⑥	Angular shelf brackets for wooden and glass shelves	▶ 34
⑦	Glass shelf	on request
⑧	Connection bar	▶ 35
⑨	Shelf brackets 2 H	▶ 33, 33
⑩	Lift-out preventers for shelf	▶ 46
⑪	Shelf brackets 3 H	▶ 34
⑫	Steel shelf	▶ 45
⑬	Brackets 3 H extra heavy duty	▶ 34
⑭	Low front strip	▶ 48
⑮	Baseleg H 16	▶ 31
⑯	Plinth	▶ 32
⑰	Scanning ticket strips H 4	▶ 49

Wall shelf with slat panels and rear support bars

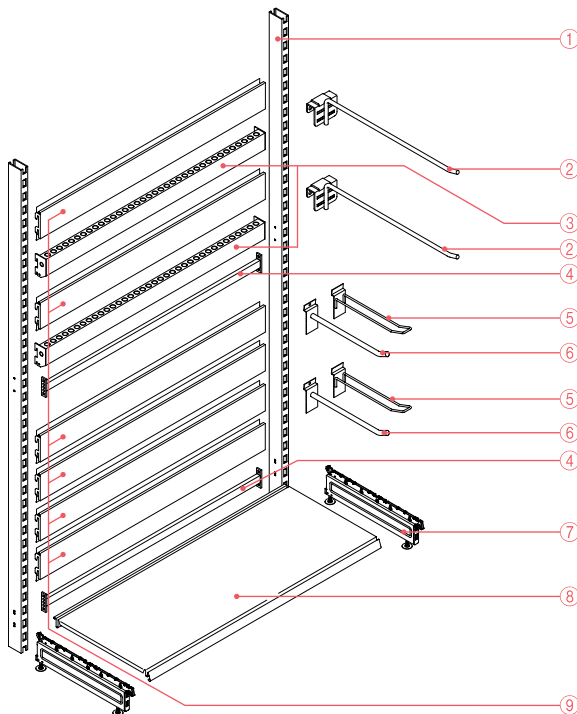

Z4287

①	Upright	▶ 25, 26
②	Hook-on bracket	▶ 53
③	Rear support bar 50x20 mm	▶ 52
④	Tie-bar	▶ 26
⑤	Blister hook	▶ 43
⑥	Holder heavy type	▶ 44
⑦	Baseleg H 16	▶ 31
⑧	Steel shelf	▶ 45
⑨	Slat-panel	▶ 43

TegoClassic Components Overview

Wall shelf with subdivided shelves

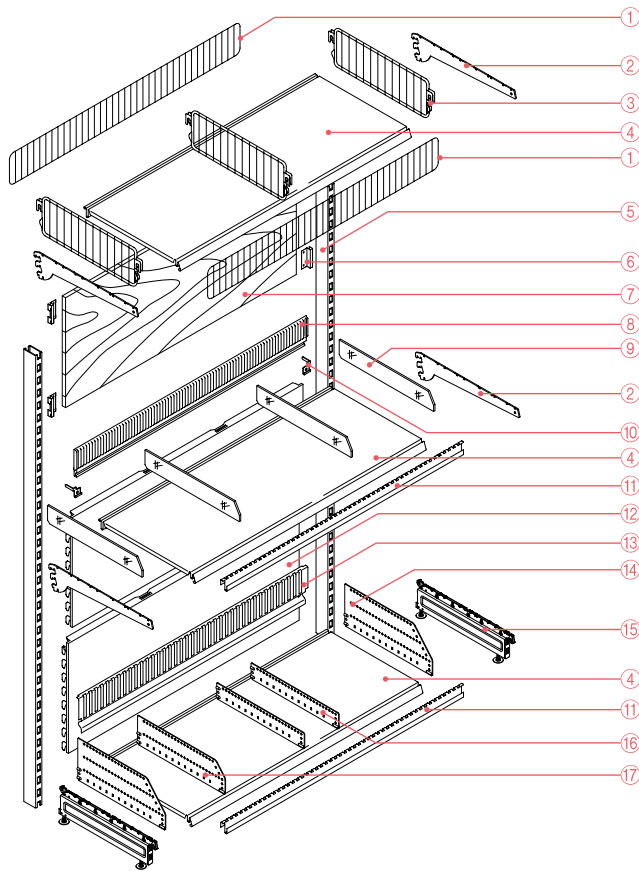

①	Front grid, front and back	➡ 49
②	Shelf brackets	➡ 33, 34
③	Divider grid	➡ 49
④	Steel shelf	➡ 45
⑤	Upright	➡ 25, 26
⑥	Back panel clips	➡ 39
⑦	Wooden back panel	on request
⑧	Dividing strip	➡ 47
⑨	Glass divider H 5.5	on request
⑩	Lift-out preventers for shelf	➡ 46
⑪	Border strip H 1	➡ 48
⑫	Back panel	➡ 36
⑬	Border strip H 5	➡ 48
⑭	Divider sheet H 15 quadrant	➡ 48
⑮	Baseleg H 16	➡ 31
⑯	Divider sheet H 5.5 quadrant	➡ 48
⑰	Divider sheet H 10 quadrant	➡ 48

Z4288

Subdivided shelf

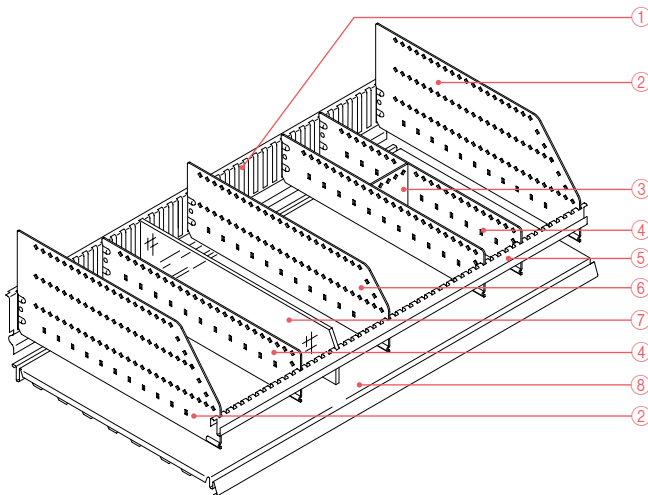

①	Border strip H 5	➡ 48
②	Divider sheet H 15 quadrant	➡ 48
③	Subdivider sheet H 5.5 quadrant	on request
④	Divider sheet H 5.5 quadrant	➡ 48
⑤	Border strip H 1	➡ 48
⑥	Divider sheet H 10 quadrant	➡ 48
⑦	Glass divider H 5.5	on request
⑧	Steel shelf	➡ 45

Z4281

TegoClassic Components Overview

Wall shelf with back panel SL, back panel RL and various hooks

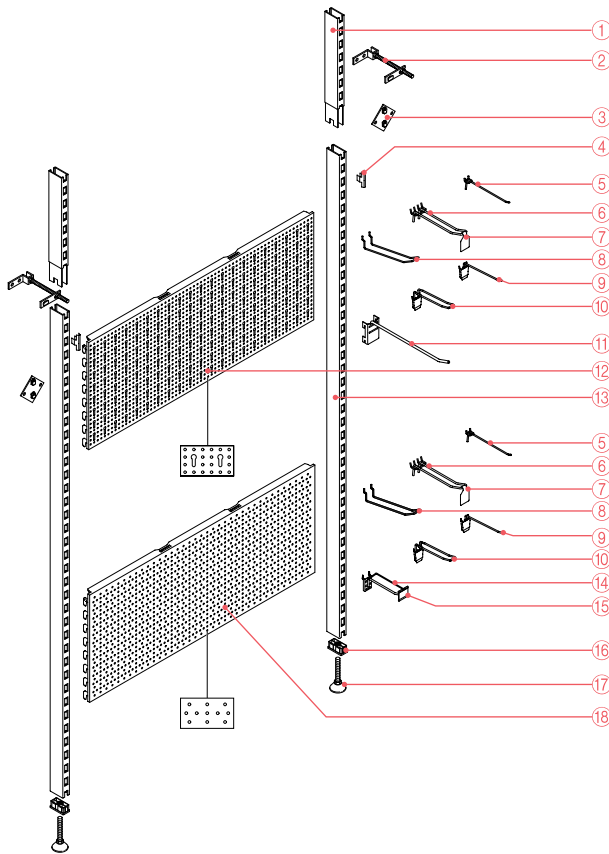

① Upright extension	➡ 27
② Wall fixing brackets for upright, adjustable	➡ 30
③ Wall fixing brackets upright	➡ 29
④ Back panel safeguard	➡ 38
⑤ Single hook	➡ 40
⑥ Special hook for blister packings	on request
⑦ Retrofit flag	➡ 41
⑧ Hook for blister packings	➡ 40
⑨ Single hinged hook	➡ 40
⑩ Double hinged hook	➡ 40
⑪ Holder heavy type	➡ 43
⑫ Back panel SL	➡ 37
⑬ Upright	➡ 25, 26
⑭ Holder heavy type	➡ 41
⑮ Label jacket	➡ 41
⑯ End tap	➡ 28
⑰ Foot disk	➡ 28
⑱ Back panel RL	➡ 37

Z4289

Wall shelf with wire articles

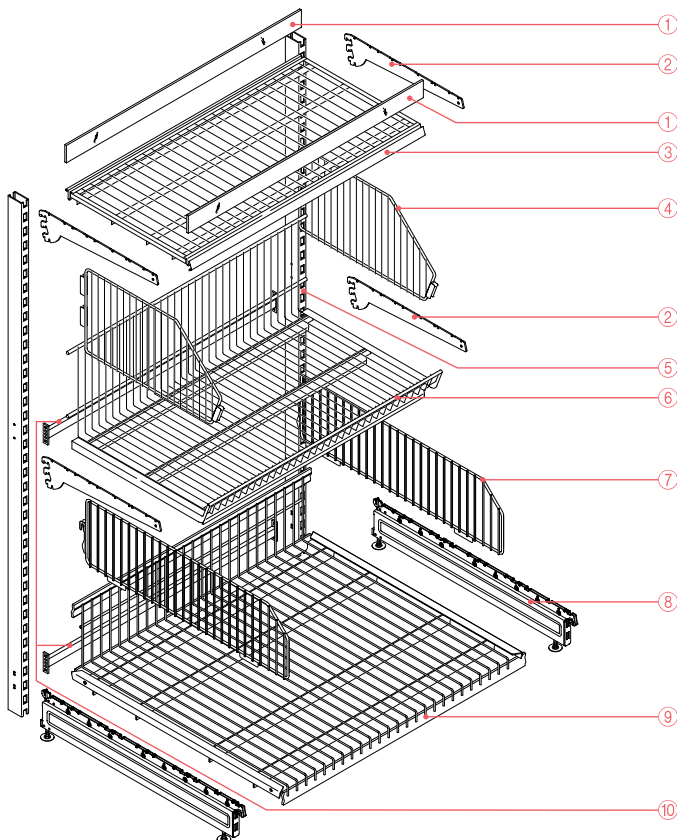

① Low front strip	➡ 48
② Shelf brackets 3 H	➡ 34
③ Grid shelf with front and back groove	➡ 55
④ Divider for TEK wire baskets	➡ 55
⑤ Upright	➡ 25, 26
⑥ TEK wire basket	➡ 55
⑦ Divider for grid shelf PBE	➡ on request
⑧ Baseleg H 16	➡ 31
⑨ Grid shelf PBE	➡ 56
⑩ Tie-bar	➡ 26

Z4290

TegoClassic Components Overview

Fascia

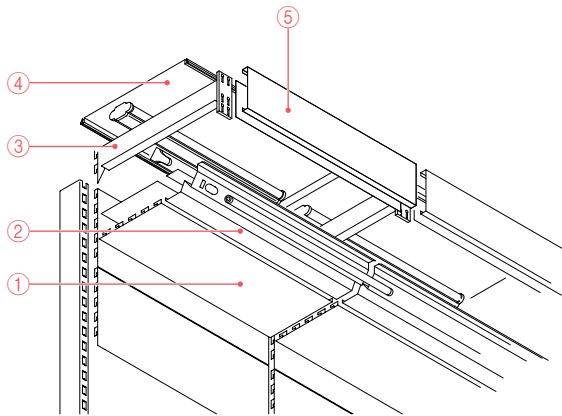

①	Back panel	➡ 36
②	Lower soffit, shaped	➡ 52
③	Fascia bracket H 20	➡ 51
④	Steel shelf (or soffit, on request)	➡ 45
⑤	Fascia H 20	➡ 51

Load capacity (with shelf):

T 23 **no load capacity**

T 33 **no load capacity**

T 43 up to max. 130 kg load capacity

T 53 up to max. 120 kg load capacity

T 63 up to max. 110 kg load capacity

Z4284

TegoClassic Technical Information

Colour and finish code / Order information

Colour code standard colours

01	Plastic white
24	Jura white, similar to RAL 9001
66	Light grey, RAL 7035
88	White aluminium, RAL 9006



Standard colour group code

①	Standard colours 24, 66, 88
②	Standard colours 01, 66, 88

Finish code

01	Plastic white		
02	Black		
12	Gentian violet, RAL 5010		
17	Flame red, RAL 3000		
23	Pure white, RAL 9010		
24	Jura white, similar to RAL 9001		
28	Rape yellow, RAL 1021		
37	zinc plated, glossy (galvanized)		
38	chrome plated		
42	float glass, clear, smooth		
44	Plastic		
45	die cast		
47	Rubber, black		
51	zinc galvanized		
66	Light grey, RAL 7035		
67	Silver grey, RAL 7001		
68	Jet black, RAL 9005		
71	Slate grey, RAL 7015		
86	Anthracite grey, RAL 7016		
87	Grey aluminium, RAL 9007		
88	White aluminium, RAL 9006		

Note

The colour samples show only the colour shade, not the quality of the surface of the respective product!
Slight colour differences are possible for technical reasons. These are not deemed to be defects. Our previous colour charts are hereby invalid.

Special colours

Other special colours are available on request.

On ordering, we add a surcharge of EUR 25.- for each special colour.

DecoCoat

Information about our DecoCoat coating system is available in the DecoCoat brochure, which you can order, free of charge, on our website www.tegometall.com.

Order information

Composition of item numbers

Example:

Foot disc, H 7, plastic white = 113349 01

113349 01	=	Item group
113349 01	=	Item basic number
113349 01	=	Finish code

Order example

Back panel SL, L 100 cm, H 40 cm, in special colour rape yellow (RAL 1021)
Item number **134293** and required colour:
Rape yellow (RAL 1021) = colour code **28**

To place this order, the item number must be: **134293 28**.

TegoClassic Technical Information

System sizes

Dimensions

The specified dimensions are generally nominal dimensions.

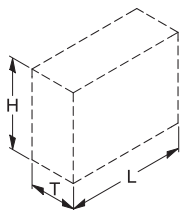

Z1683

Key to abbreviations:

H	=	Height
L	=	Length
T	=	Depth

H-slots

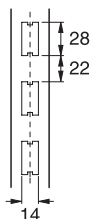

Z1688

Nominal dimensions – Axis spacing

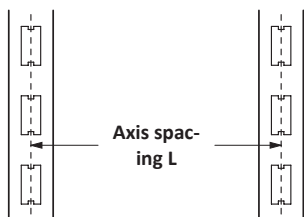

Z1410

The precise axis spacing is:

for L 62.5 cm	=	62.5 cm
for L 100 cm	=	100 cm
for L 125 cm	=	125 cm

SL

Combined round and key holes

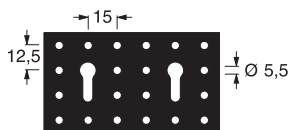

Z1684

RL

Round holes

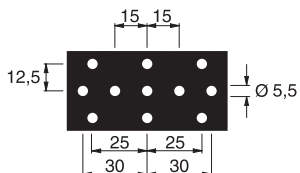

Z1685

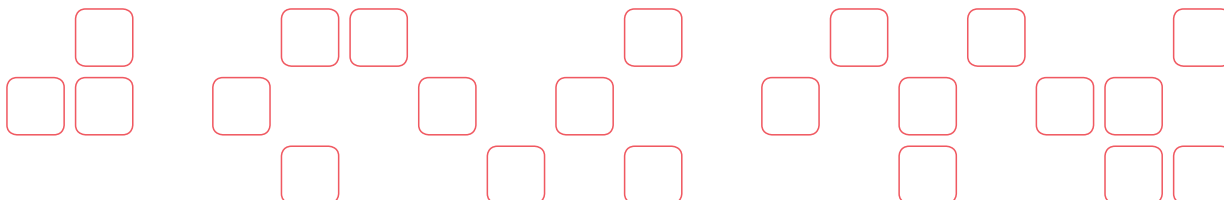





TegoClassic Technical Information

Permissible loads

Permissible loads for wall-mounted shelves and gondolas

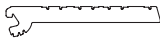
- Uniformly distributed loading over the whole shelf is required.
- The permissible stand loads can be increased by wall fixings, if the means of fixing and wall are able to safely absorb and transfer the resulting additional loads; this must be checked on site.
- Equipping the shelf stands with bay load reducing upwards.
- Ensure that all push-on connections are properly fitted.
- The shelf must not be subjected to impact loads.
- **If the shelf's maximum loading capacity is utilised, the top back panels must be secured against uplift using the back panel safeguard 107154.**
- If no load information is available or special load requirements exist, please contact our technical department.
- If both sides are loaded (gondola) the same loads can be applied on the right and left as for wall-mounted shelves.
- Refer to the "Permissible load for shelves on baselegs" table for the loading capacity of the baseleg shelves.
- The uprights of wall-mounted shelves must be fixed with wall fixings from a height of 220 cm.

Permissible load for shelves on brackets

Permissible load per shelf in kg (Loading information for brackets is only applicable in conjunction with rectangular uprights)																
Support type	Bracket 2 H  Z1596				Bracket 3 H  Z1597		Bracket 3 H extra heavy duty  Z1426				Bracket 4 H extra heavy duty  Z1425					
Shelf depth in cm	T 25	T 30	T 37	T 47	T 47	T 57	T 37	T 47	T 57	T 67	T 37	T 47	T 57	T 67	T 77	
Axis spacing in cm	62.5	120	110	100	90	170	150	230	230	180	160	230	230	255	230	200
100	120	110	100	90	170	150	200	230	180	160	200	290	255	230	200	
125	120	110	100	90	170	150	155	230	180	160	155	260	255	230	200	

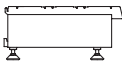
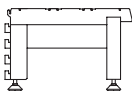

Permissible load for shelves on baselegs

Permissible load per shelf in kg (Loading information for baselegs is only valid in conjunction with rectangular uprights)						
Support type	Baselegs H 16 or H 26  Z1600  Z1601					
Shelf depth in cm	T 37	T 47	T 57	T 67	T 77	
Axis spacing in cm	62.5	230	260	360	360	350
100	200	290	310	350	290	
125	155	260	270	310	270	

TegoClassic Technical Information

Permissible loads

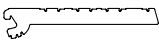
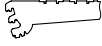
Permissible load of grid shelves on brackets or baselegs

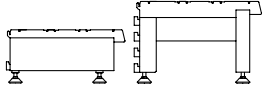
Permissible load per grid shelf in kg (Loading information for brackets and baselegs is only applicable in conjunction with rectangular uprights)												
Support type		Bracket 2 H		Bracket 3 H		Bracket 3 H heavy duty				Baselegs H 16 or H 26		
												
		Z1596		Z1597		Z1426				Z1600 Z1601		
Shelf depth in cm		T 37	T 47	T 47	T 57	T 37	T 47	T 57	T 67	T 37	T 47	T 57
Axis spacing in cm	62.5	100	90	170	150	200	230	180	160	200	230	250
	100	100	90	170	150	130	180	180	160	130	180	180
	125	100	90	170	150	130	170	180	160	130	170	180

Permissible total load for wall-mounted shelf stands or gondolas if using baseleg H8

(perm. total load of all shelves, not including baseleg shelf, in kg)

Calculation of the average depth:

The average depth is calculated from the sum of the depths of the shelves – not including the baseleg shelf – divided by the number of shelves – not including the baseleg shelf.

Example:

Total of all shelves not including baseleg shelf: $25 + 37 + 37 + 47 = 146$

Number of shelves not including baseleg shelf: **4**

Average depth: $146 / 4 = 36.5$

Permissible total load [kg] for an average depth D		
Upright	T 30 / T 37	T 47
	Baseleg depth of at least 47 cm	Baseleg depth of at least 57 cm
60×30	230	180
80×30	250	200
110×30	250	200

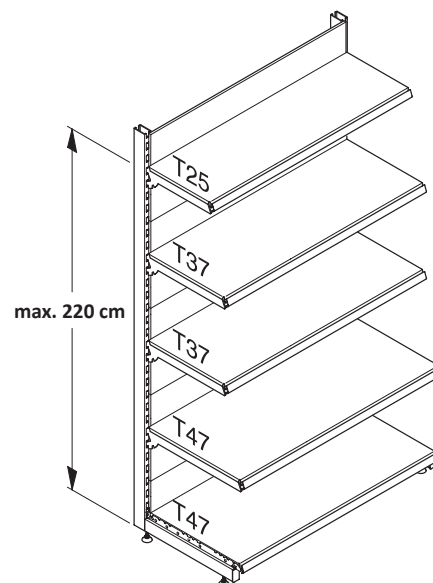

Z3665

Wall-mounted shelf stands with an average depth D (T) of 37 and a baseleg shelf T 47.

TegoClassic Technical Information

Permissible loads

Permissible total load for wall-mounted shelf stands or gondolas if using baseleg H 16 and H 26

(perm. total load of all shelves, not including baseleg shelf, in kg)

Calculation of the average depth:

The average depth is calculated from the sum of the depths of the shelves – not including the baseleg shelf – divided by the number of shelves – not including the baseleg shelf.

Example:

Total of all shelves not including baseleg shelf: $37 + 47 + 47 + 47 + 57 = 235$

Number of shelves not including baseleg shelf: **5**

Average depth: $235 / 5 = 47$

Permissible total load [kg] for an average depth D					
	T 37 Baseleg depth of at least 47 cm	T 47 Baseleg depth of at least 57 cm	T 57 Baseleg depth of at least 67 cm	T 67 Baseleg depth of at least 77 cm	T 77 Baseleg depth of at least 77 cm
Upright					
60×30	250	200	150	–	–
80×30	400	350	300	250	200
110×30	600	500	450	400	400

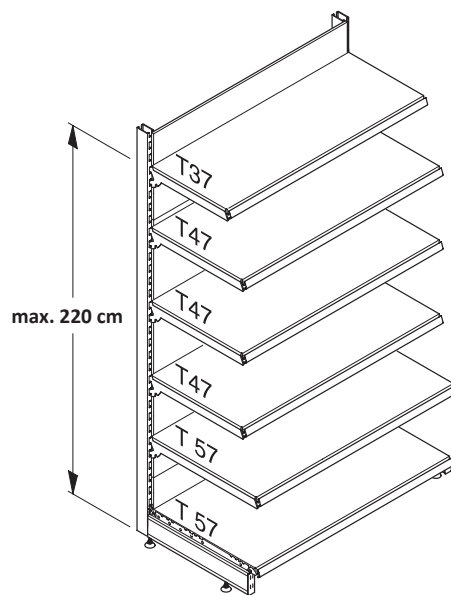

Z3666

Wall-mounted shelf stands with an average depth D (T) of 47 and a baseleg shelf T 57.

TegoClassic Technical Information

Internal corners

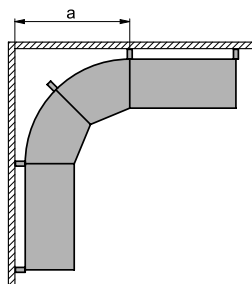

Z1619_c

Wall shelf

a = 104.5 cm for upright 60×30 mm

a = 106.5 cm for upright 80×30 mm

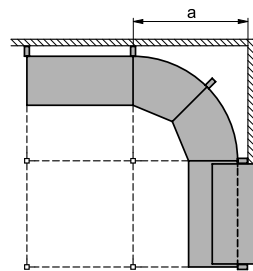

Z1620_c

Shop (axis spacing 100 cm)

a = 101.5 cm for upright 30×30 mm

Internal corner 90°

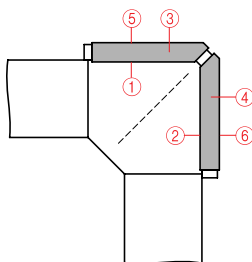

Z1625_c

- ① Back panel, internal corner 90° left
- ② ditto ① right
- ③ Gondola cover strip internal corner 90° right
- ④ ditto ③ left
- ⑤ Back panel, internal corner 90° facing panel right
- ⑥ ditto ⑤ left

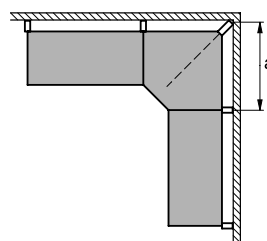

Z1627_c

a = 74 cm for upright 60×30 mm

a = 76 cm for upright 80×30 mm

a = 79 cm for upright 110×30 mm

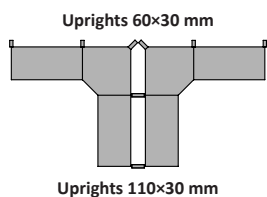

Z1628_c

Internal corner 45°

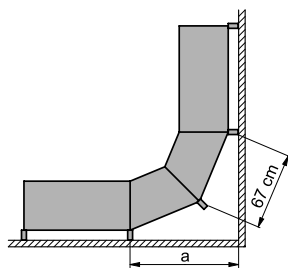

Z1626_c

a = 93.6 cm for upright 60×30 mm

a = 95.6 cm for upright 80×30 mm

TegoClassic Technical Information

External corners

External corner 90°

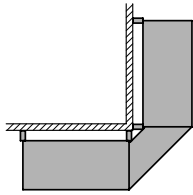

Z1621_c

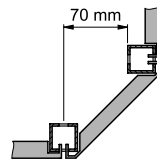

Z1622_c

for uprights 30×30mm

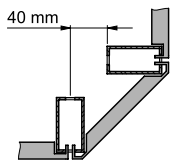

Z1623_c

for uprights 60×30mm

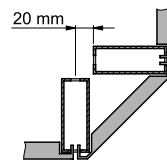

Z1624_c

for uprights 80×30mm

Note:

110×30 mm uprights **cannot** be used!

External corner 45°

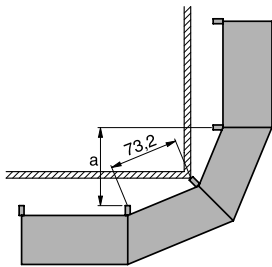

Z1629_c

a = 89.6 cm for upright 60×30 mm
a = 87.6 cm for upright 80×30 mm



The optimum shelving for every industry.

1 Uprights and Wall-mount Uprights

Wall-mount uprights with H-slots

Wall-mount upright

U-profile 23.5x30x23.5 mm, H-slots on one side

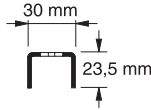

Z0001/Z0002

Size cm	Item No.	Finish	Quantity per VE
H*			
160	111014	①	
200	111010	①	
240	113266	①	

*) further heights are available on request

Upright 60x30 mm

H-slots on two sides, for wall-mounted shelves and gondolas

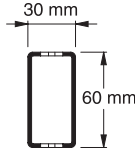

Z0012/Z0013

H	Item No.	Finish	Quantity per VE
140	111702	①	
160	111703	①	
180	111011	①	
200	111012	①	
210	111126	①	
220	111013	①	
240	111705	①	
260	111706	①	
280	111708	①	
300	111707	①	

Upright 60x30 mm

H-slots on two sides, for wall-mounted shelves and gondolas, with holes for tie-bars

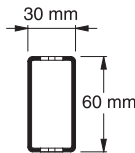
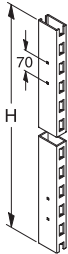

Z0014/Z0013

H	Item No.	Finish	Quantity per VE
140 ¹⁾	111712	①	
160 ¹⁾	111216	①	
180 ¹⁾	112220	①	
200 ¹⁾	112224	①	
220 ²⁾	112228	①	

¹⁾ 4 holes for 2 tie-bars

²⁾ 6 holes for 3 tie-bars

Upright 80x30 mm

H-slots on two sides, for wall-mounted shelves and gondolas

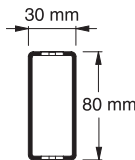
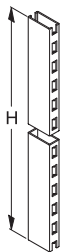

Z0016/Z0019

H	Item No.	Finish	Quantity per VE
140	111017	①	
160	111018	①	
180	111019	①	
200	111020	①	
210	111526	①	
220	111021	①	
240	111765	①	
260	111766	①	
280	111767	①	
300	111768	①	

1

1 Uprights and Wall-mount Uprights

Upright 80×30 mm

H-slots on two sides, for wall-mounted shelves and gondolas, with holes for tie-bars

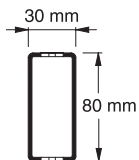
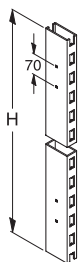

Z0018/Z0019

Size cm	Item No.	Finish	Quantity per VE
H			
160 ¹⁾	112296	①	
180 ¹⁾	112300	①	
200 ¹⁾	112304	①	
220 ²⁾	112308	①	

¹⁾ 4 holes for 2 tie-bars
²⁾ 6 holes for 3 tie-bars

Upright 110×30 mm

H-slots on two sides, for wall-mounted shelves and gondolas

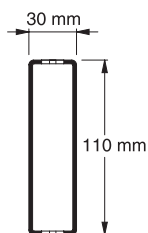
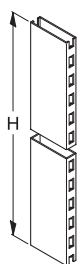

Z0020/Z0021

Size cm	Item No.	Finish	Quantity per VE
H			
180	113267	①	
200	113268	①	
220	113269	①	
240	113270	①	

Upright 110×30 mm

H-slots on two sides, with holes for tie-bars

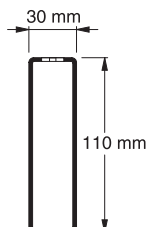
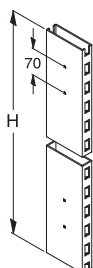

Z0022/Z0021

Size cm	Item No.	Finish	Quantity per VE
H			
150 ¹⁾	112374	①	
160 ¹⁾	112376	①	
180 ¹⁾	112380	①	
200 ¹⁾	112384	①	
220 ²⁾	112388	①	

¹⁾ 4 holes for 2 tie-bars
²⁾ 6 holes for 3 tie-bars

Accessories for uprights

Tie-bar

for wall-mounted shelves and gondolas without back panels and for mobile gondolas. With screws and nuts. Profile 30×20 mm, hole spacing 70 mm

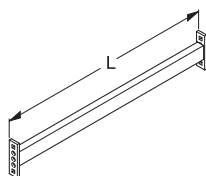

Z0032

Size cm	Item No.	Finish	Quantity per VE
L			
59.5	117800	①	
97	117804	①	
122	117806	①	

1 Uprights and Wall-mount Uprights

Upright extension 60x30 mm

H-slots on two sides

Note: All extensions only for back panel height increase.
Not for suspension of shelves.

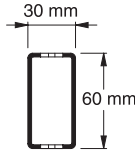

Z0033/Z0013

Size cm	Item No.	Finish	Quantity per VE
H			
10	112013	①	
20	111556	①	
40	111557	①	
60	111992	①	

Upright extension 80x30 mm

H-slots on two sides

Note: All extensions only for back panel height increase.
Not for suspension of shelves.

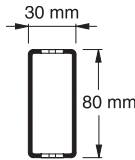
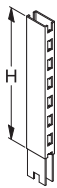

Z0033/Z0019

Size cm	Item No.	Finish	Quantity per VE
H			
10	112014	①	
20	111558	①	
40	111559	①	
60	111993	①	

Upright extension 110x30 mm

H-slots on two sides

Note: All extensions only for back panel height increase.
Not for suspension of shelves.

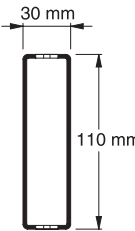

Z0033/Z0021

Size cm	Item No.	Finish	Quantity per VE
H			
10	113018	①	
20	113020	①	
40	113024	①	
60	113028	①	

Top caps for uprights (Pair)

Plastic, suitable for gondola cover strip

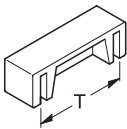

Z0038

T	Item No.	Finish	Quantity per VE
6 ¹⁾	114980	②	25
8 ²⁾	114981	②	25
11 ³⁾	114982	②	25

¹⁾ Upright 60x30 mm = T 6

²⁾ Upright 80x30 mm = T 8

³⁾ Upright 110x30 mm = T 11

Top cap 30x30 mm for upright

suitable for back panel cover strip, plastic



Z0039

Item No.	Finish	Quantity per VE
117872	②	50

1

1 Uprights and Wall-mount Uprights

Top cap 60x30 mm for upright
suitable for back panel cover strip, plastic

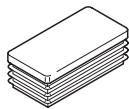

Z0041

Top cap 80x30 mm for upright
suitable for back panel cover strip, plastic

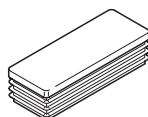

Z1510

End tap
for upright 30x30 mm, internally threaded M 10, die-casting

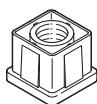

Z0042

End tap
for upright 60x30 mm, internally threaded M 10, die-casting

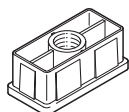

Z0044

End tap
for upright 80x30 mm, internally threaded M 10, die-casting

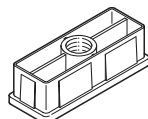

Z0045

Foot disk
Plastic, threaded M 10

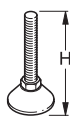

Z0046

Foot disk with pin
Plastic, threaded M 10

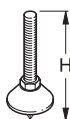

Z0047

Size cm	Item No.	Finish	Quantity per VE
	117876	②	50
	117879	②	50
	113346	45	50
	113347	45	50
	117866	45	50
H			
7,0 ¹⁾	113349	②	50
9,5 ²⁾	113354	②	50
¹⁾ Adjustment range 35 mm		²⁾ Adjustment range 60 mm	
H			
8	111427	01	50



1 Uprights and Wall-mount Uprights

Extension element with foot disk
for upright 80×30 mm

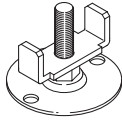

Z3583

Size cm			Item No.	Finish	Quantity per VE
H	∅				
8	10		118826	①	

Upright ceiling fixing 30×30 mm
Comprising tube insert and foot disk with pin.
Adjustment range 40 mm. Foot disk white

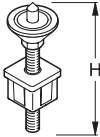

Z0049

H					
8			113377	45	50

Upright ceiling fixing 60×30 mm
Comprising tube insert and foot disk with pin.
Adjustment range 40 mm. Foot disk white

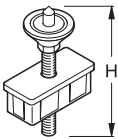

Z0051

H					
8			113375	45	50

Wall fixing brackets upright
Sheet steel, zinc-plated

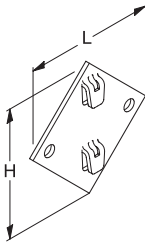

Z3584

L	H				
10	10		117799	51	50

Wall fixing brackets for upright, top
Sheet steel, zinc-plated

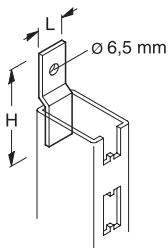

Z0053

L	H				
2	6		117790	37	50

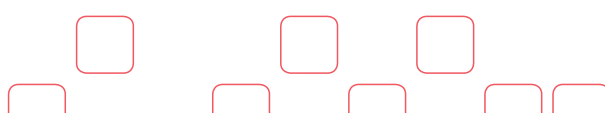

1

1 Uprights and Wall-mount Uprights

Wall fixing brackets for upright, adjustable

Threaded rod with adjustable fittings, zinc-plated

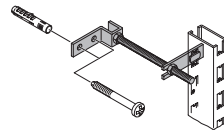
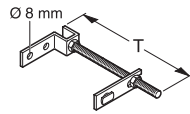

Z0054/Z1881

Size cm		Item No.	Finish	Quantity per VE
T				
30		113355	37	50

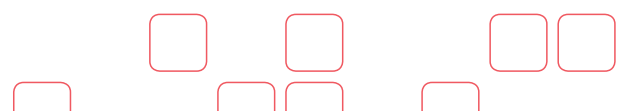

2 Baselegs and Brackets

Baselegs

Baseleg light-weight H 8

height adjustable with two foot disks. (Suitable for base shelf support)

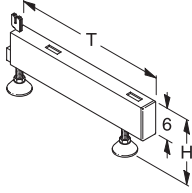

Z0055

Base shelf support

suitable for baseleg light-weight H 8

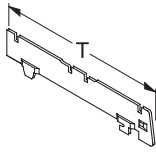

Z0057

Baseleg H 16

low version with 2 foot disks, height adjustable.
For use with crash bar and plinth.

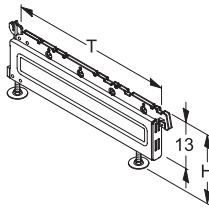

Z4292

Baseleg H 26

high version, for use with crash bar and plinth.
Height adjustable with two foot disks.

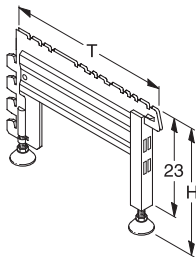

Z0059

Size cm

Item No.

Finish

Quantity per VE

T	H			
30	8		120481	①
37	8		120482	①
47	8		120484	①

T				
30			120102	①
37			120104	①
47			120106	①

T	H			
37	16		122402	①
47	16		122404	①
57	16		122406	①
67	16		122408	①
77	16		122410	①

T	H			
37	26		120302	①
47	26		120304	①
57	26		120306	①
67	26		120308	①
77	26		120310	①

2 Baselegs and Brackets

Plinthes

Plinth

Sheet steel, for wall-mounted shelves and gondolas, bottom with rubber profile

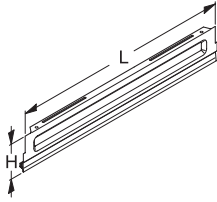

Z0060/Z0869



Size cm		Item No.	Finish	Quantity per VE
L	H			
62.5	16	120948	①	
62.5	26	120830	①	
100	16	120942	①	
100	26	120834	①	
125	16	120944	①	
125	26	120836	①	

Plinth, internal corner round 45°

Sheet steel, bottom with rubber profile

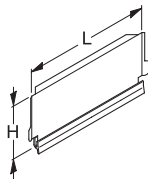

Z0062/Z0869



L	H			
33	16 ¹⁾	124754	①	
33	26 ¹⁾	121983	①	
41	16 ²⁾	124753	①	
41	26 ²⁾	121982	①	
48	26 ³⁾	121981	①	

¹⁾ for T 57

²⁾ for T 47

³⁾ for T 37

Plinth, internal corner 90°

Sheet steel, bottom with rubber profile

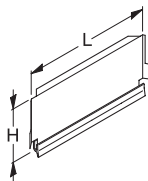

Z0063/Z0869



L	H			
15	16 ¹⁾	124762	①	
15	26 ¹⁾	121885	①	
30	16 ²⁾	124761	①	
30	26 ²⁾	121884	①	

¹⁾ for T 57

²⁾ for T 47

Plinth, external corner 90°

Sheet steel, bottom with rubber profile

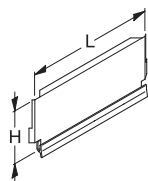

Z0064/Z0869



L	H			
78	16 ¹⁾	124757	①	
78	26 ¹⁾	121771	①	
93	16 ²⁾	124758	①	
93	26 ²⁾	121772	①	

¹⁾ for T 47

²⁾ for T 57

Plinth, internal corner 45°

Sheet steel, bottom with rubber profile

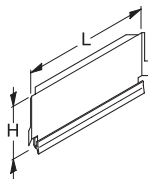

Z0065/Z0869



L	H			
23	16 ¹⁾	122336	①	
23	26 ¹⁾	122376	①	
30	16 ²⁾	122334	①	
30	26 ²⁾	122374	①	

¹⁾ for T 57

²⁾ for T 47



2 Baselegs and Brackets

Plinth end

Sheet steel, bottom with rubber profile

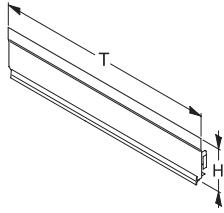

Z0067/Z0869

Size cm

Item No.

Finish

Quantity per VE

T	H			
47	26	121795	①	
57	26	121796	①	

Accessories for baselegs

Base draw unit H 10

Sheet steel, with roller guides, for baseleg H 16. Maximum loading capacity 120 kg

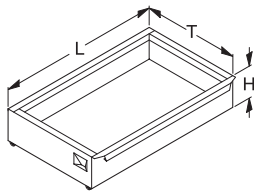

Z0069

L	T			
62.5	37	122040	①	
62.5	47	122030	①	
100	37	122044	①	
100	47	122034	①	
125	37	122046	①	
125	47	122036	①	

Base draw unit H 18

Sheet steel, with roller guides, for baseleg H 26. Maximum loading capacity 120 kg

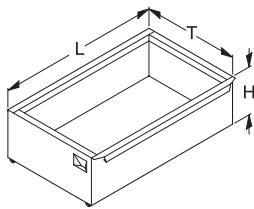

Z0070

L	T			
62.5	37	122000	①	
62.5	47	122020	①	
100	37	122004	①	
100	47	121827	①	
125	37	122006	①	
125	47	122026	①	

Shelf brackets

Shelf brackets 2 H (Pair)

Sheet steel, with 2 hooks. For left and right side. Inclinal (20°, 35°) downwards in uprights and wall-mount uprights

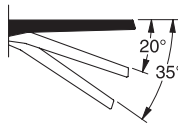
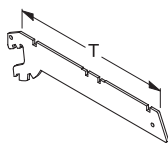

Z0074/Z0075

T				
20		121210	①	
25		121212	①	
30		121214	①	

Shelf brackets 2 H (Pair)

Sheet steel, with 2 hooks. For left and right side. Inclinal: two positions down (20°, 35°) in uprights 80×30 and 110×30 mm, one position (20°) in wall-mount uprights, uprights 30×30, 50×30 and 60×30 mm.

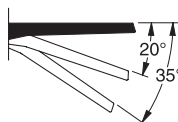
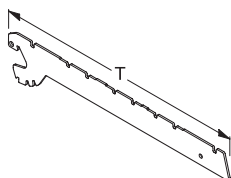

Z3776/Z0075

T				
37		121603	①	

2 Baselegs and Brackets

Shelf brackets 2 H (Pair)

Sheet steel, with 2 hooks. For left and right side. Inclinal (20°) in uprights 60×30, 80×30 and 110×30 mm.

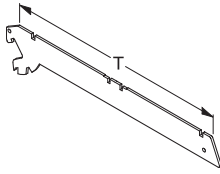

Z0078/Z0079

Size cm

Item No.

Finish

Quantity per VE

T

47

121604

①

Shelf brackets 3 H (Pair)

Sheet steel, with 3 hooks. For left and right side. Inclinal (10°, 20°) in uprights 60×30, 80×30 and 110×30 mm.

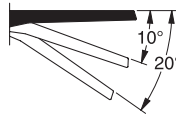
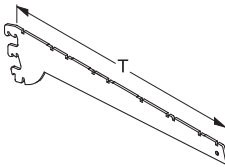

Z0082/Z0083

T

47

121605

①

57

121606

①

Brackets 3 H extra heavy duty (Pair)

Sheet steel, heavy duty version, **no slope settings**, to fit uprights 60×30, 80×30 and 110×30 mm. With 3 insert hooks

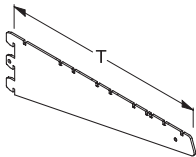

Z0084/Z1860

T

37

128009

①

47

128022

①

57

128023

①

67

121634

①

Brackets 4 H extra heavy duty (Pair)

Sheet steel, heavy duty version, **no slope settings**, to fit uprights 60×30, 80×30 and 110×30 mm. With 4 insert hooks

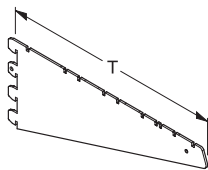

Z0948/Z1860

T

47

121144

①

57

121146

①

67

121148

①

77

128024

①

Angular shelf brackets for wooden and glass shelves (Pair)

Sheet steel, left and right, 2 slope settings (20°, 35°) downwards in wall-mount uprights and uprights

Load: 100 kg per pair

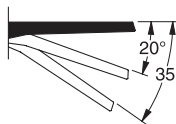
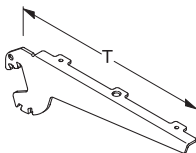

Z0088/Z0089

T

17

123241

①

22

121511

①

27

123242

①

37

123243

①

47

123244

①

2 Baselegs and Brackets

Accessories for shelf brackets

Screw accessories for angular shelf brackets (100 pieces)

Zinc-plated screws 3.5x16 mm in a bag

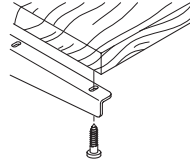

Z1512/Z0090

Size cm

Item No.

Finish

Quantity per VE

121556

37

100

Glass supports for angular shelf brackets (100 pieces)

PVC plugs, in a bag

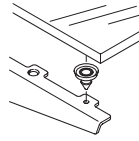

Z1513/Z0091

121554

44

100

Connection bar

for angular bracket for glass shelf, with fixtures

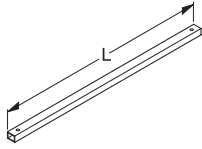

Z0092

L

62.5

122120

①

100

122143

①

125

122144

①

3 Back Panels and Hooks

Back panels GL

Back panel GL, painted on one side
Sheet steel

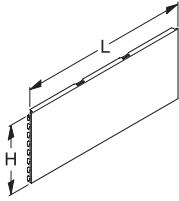

Z0106/Z2098

Size cm		Item No.	Finish	Quantity per VE
L	H			
62.5	20	130292	①	
62.5	30	130294	①	
62.5	40	130296	①	
100	20	131193	①	
100	30	134316	①	
100	40	131200	①	
100	50	139404	①	
125	20	131186	①	
125	30	134317	①	
125	40	131298	①	
125	50	139406	①	

Back panel GL, painted on both sides
Sheet steel

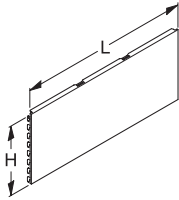

Z0106/Z2098

L	H			
62.5	20	130502	①	
62.5	40	130506	①	
100	20	134914	①	
100	40	134915	①	
125	20	134917	①	
125	40	134918	①	

Back panel GL, internal corner round 45°
Sheet steel

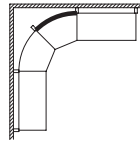
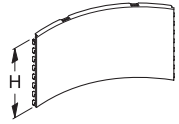

Z0108/Z2084

H				
20		134331	①	
30		134335	①	
40		134332	①	

Back panel GL, internal corner 90°
Sheet steel

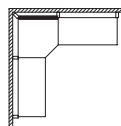
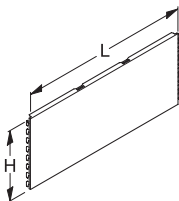

Z0109/Z2086

H				
20 ¹⁾		131845	①	
30 ¹⁾		131846	①	
40 ¹⁾		131847	①	
20 ²⁾		131848	①	
30 ²⁾		131849	①	
40 ²⁾		131850	①	

¹⁾left ²⁾right

Back panel GL, internal corner 45°
Sheet steel

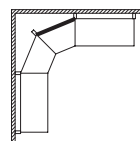
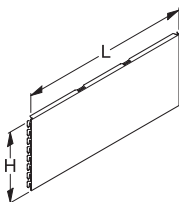

Z0113/Z2085

H				
20		130602	①	
30		130604	①	
40		130606	①	



3 Back Panels and Hooks

Back panels SL

Back panel SL, painted on one side

Sheet steel with combined round and key holes (SL)

Note: For very high loading of back panel L 125 we recommend use of the back panel reinforcement.

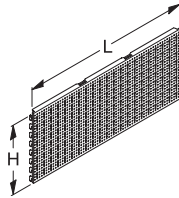

Z0115/Z2098

Size cm		Item No.	Finish	Quantity per VE
L	H			
62.5	40	131113	①	
100	40	134293	①	
125	40	131300	①	

Back panel SL, painted on both sides

Sheet steel with combined round and key holes (SL)

Note: For very high loading of back panel L 125 we recommend use of the back panel reinforcement.

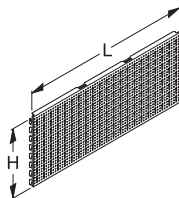

Z0116/Z2098

Size cm		Item No.	Finish	Quantity per VE
L	H			
62.5	40	134923	①	
100	40	134921	①	
125	40	134922	①	

Back panels RL

Back panel RL, painted on one side

Sheet steel, with round holes (RL)

Note: For very high loading of back panel L 125 we recommend use of the back panel reinforcement.

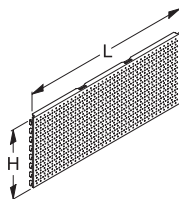

Z0121/Z2098

Size cm		Item No.	Finish	Quantity per VE
L	H			
62.5	40	131513	①	
100	40	134294	①	
125	40	131808	①	

Back panel RL, painted on both sides

Sheet steel, with round holes (RL)

Note: For very high loading of back panel L 125 we recommend use of the back panel reinforcement.

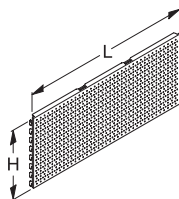

Z0121/Z2098

Size cm		Item No.	Finish	Quantity per VE
L	H			
62.5	40	134924	①	
100	40	134925	①	
125	40	134926	①	

3 Back Panels and Hooks

Back panel RL, internal corner round 45°
Sheet steel, with round holes (RL)

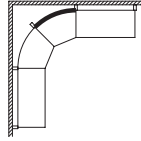
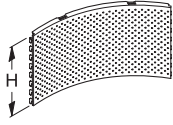

Z0122/Z2084

Size cm		Item No.	Finish	Quantity per VE
H				
40		134334	①	

Back panel RL, internal corner 90°
Sheet steel, with round holes (RL)

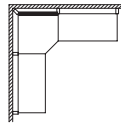
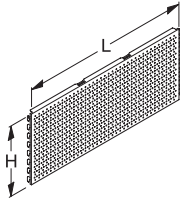

Z0123/Z2086

Size cm		Item No.	Finish	Quantity per VE
H				
40 ¹⁾		134326	①	
40 ²⁾		134327	①	

¹⁾left ²⁾right

Back panel RL, internal corner 45°
Sheet steel, with round holes (RL)

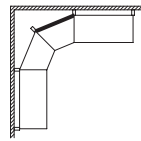
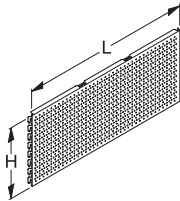

Z0124/Z2085

Size cm		Item No.	Finish	Quantity per VE
H				
40		131084	①	

Supplements for back panels

Back panel safeguard

for securing back panels against lifting out

Note: This part must be used to secure the top-most back panels of highly loaded shelving (central upright) against gradually lifting out.

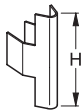

Z0618/Z0619

Size cm		Item No.	Finish	Quantity per VE
H				
5		107154	37	100

Gondola cover strip
Sheet steel

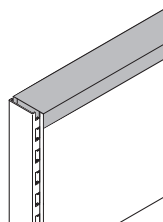
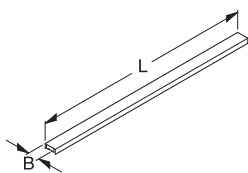

Z0127/Z4123

L	B	Item No.	Finish	Quantity per VE
62.5	6	133140	①	
62.5	8	133160	①	
62.5	11	133180	①	
100	6	131800	①	
100	8	131124	①	
100	11	134952	①	
125	6	131128	①	
125	8	131129	①	
125	11	134953	①	



3 Back Panels and Hooks

Back panel cover strip

Sheet steel, to cover back panels between uprights

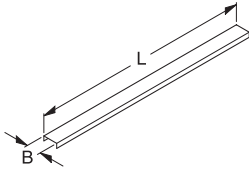

Z0130

Size cm		Item No.	Finish	Quantity per VE
L	B			
59.5	3	133598	①	
59.5	6	133607	①	
59.5	8	133613	①	
97	3	134955	①	
97	6	134959	①	
97	8	134963	①	
122	3	134956	①	
122	6	134960	①	
122	8	134964	①	

Accessories for wooden parts

Back panel clips (Pair)

Sheet steel, for hanging wooden back panels

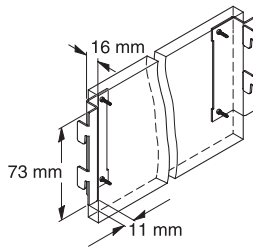

Z0533

Size cm	Item No.	Finish	Quantity per VE
	154340	①	50

Central panel clips (Pair)

Sheet steel, for hanging wooden back panels

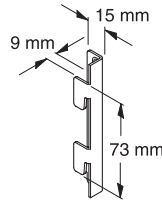
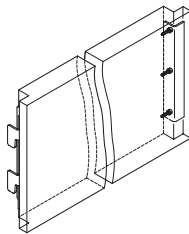

Z3926/Z3927

Size cm	Item No.	Finish	Quantity per VE
	154342	①	50

Panel clip for transverse panel

Sheet steel. Use at least 4 clips per panel

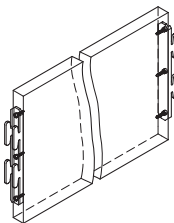

Z0535

Size cm	Item No.	Finish	Quantity per VE
	154344	37	50

3 Back Panels and Hooks

Panel clip

for lateral fascias in gondolas, complete

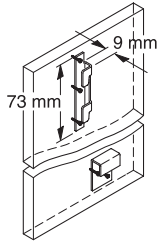

Z0536

Size cm	Item No.	Finish	Quantity per VE
	154346	37	

Hooks and special holders

Single hook

for back panel RL and SL, Ø 3.4 mm

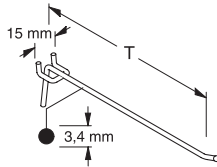

Z0136

T	Item No.	Finish	Quantity per VE
8	136580	37	50
10	136582	37	50
12	136584	37	50
16	136586	37	50
20	136588	37	50

Single hinged hook

with hinged locking device, for back panel RL and SL, Ø 4.8 mm

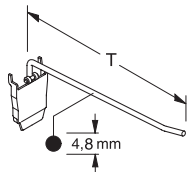

Z0137

T	Item No.	Finish	Quantity per VE
20	136562	37	25
30	136564	37	25

Hook for blister packings

for back panel RL and SL, Ø 3.4 mm

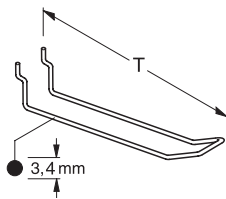

Z0140

T	Item No.	Finish	Quantity per VE
12	136510	37	50
16	136512	37	50
20	136516	37	50

Double hinged hook

with hinged locking device, for back panel RL and SL, Ø 4.8 mm

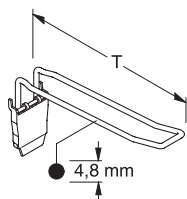

Z0142

T	Item No.	Finish	Quantity per VE
20	136452	37	25
30	136454	37	25

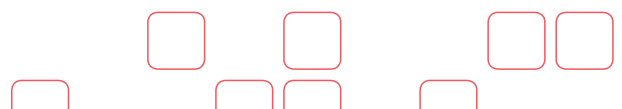

3 Back Panels and Hooks

Retrofit flag

for wire \varnothing 4 to 4.8 mm Area 27x27 mm

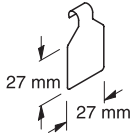

Z0148

Holder heavy type

for back panels RL

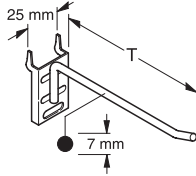

Z0962

Holder heavy type

with top label holder for label jacket, for back panels RL

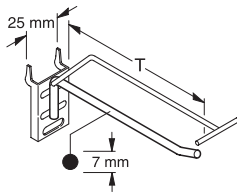

Z0963

Blister hook

with top label holder for label jacket, for back panels RL

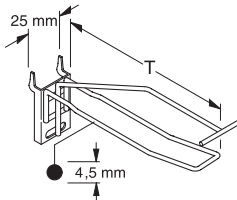

Z0965

Label jacket

for plugging onto label holder, plastic

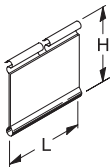

Z0966

Size cm		Item No.	Finish	Quantity per VE
		136990	44	100

T	\varnothing			
20	0.7	136210	37	50
30	0.7	136212	37	50
40	0.7	136214	37	50

T	\varnothing			
20	0.7	136220	37	
30	0.7	136222	37	
40	0.7	136224	37	

T	\varnothing			
20	0.45	136240	37	50
30	0.45	136242	37	50
40	0.45	136244	37	50

L	H			
7	4	136994	44	100

3 Back Panels and Hooks

Tool holder

with nut and bolt, for back panels SL

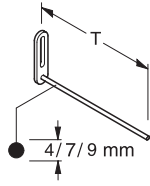

Z0149

Size cm	Item No.	Finish	Quantity per VE
T			
4 ¹⁾	136300	37	50
6 ¹⁾	136302	37	50
8 ¹⁾	136304	37	50
12 ¹⁾	136308	37	50
17 ¹⁾	136313	37	50
10 ²⁾	136320	37	50
20 ²⁾	136322	37	50
30 ²⁾	136324	37	50
10 ³⁾	136330	37	50
20 ³⁾	136332	37	50

¹⁾ Ø 4 mm, zinc-plated

²⁾ Ø 7 mm, zinc-plated

³⁾ Ø 9 mm, zinc-plated and rubber coated

Tool holder, special

with nut and bolt, for back panels SL

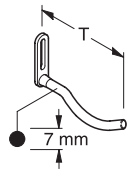

Z0150

Size cm	Item No.	Finish	Quantity per VE
T			
9 ¹⁾	136400	37	20
9 ²⁾	136405	37	20

¹⁾ Ø 7 mm, zinc-plated

²⁾ Ø 9 mm, zinc-plated and rubber coated

Tool holder for drilling machine

with nut and bolt, for back panel SL, Ø 9 mm, zinc-plated and rubber coated

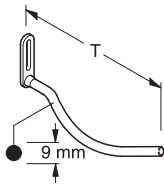

Z0151

Size cm	Item No.	Finish	Quantity per VE
T			
18	136420	37	20

Standard bolt M 5×10 mm (100 pieces)

and locking nut M 5 to fix tool holders to back panels SL



Z0152

Size cm	Item No.	Finish	Quantity per VE
	136410	37	100

Blister hook

for back panel SL, Ø 4.5 mm

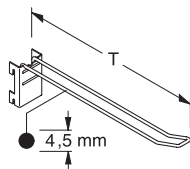

Z0153

Size cm	Item No.	Finish	Quantity per VE
T			
20	136432	37	25
20	136432	88	
30	136434	37	25
30	136434	88	



3 Back Panels and Hooks

Holder heavy type for back panels SL

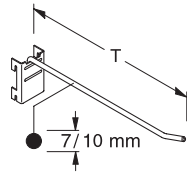

Z0154

Size cm		Item No.	Finish	Quantity per VE
T	∅			
20	0.7	136632	37	20
20	0.7	136632	88	
30	0.7	136634	37	20
30	0.7	136634	88	
40	1	136636	37	20
40	1	136636	88	

Slatted back panel walls

Slat-panel Sheet steel

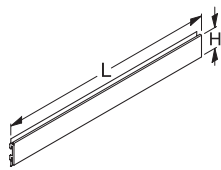

Z0167

L	H			
62.5	5	137090	①	
62.5	10	137000	①	
62.5	20	137020	①	
100	5	137094	①	
100	10	137004	①	
100	20	137024	①	
125	5	137096	①	
125	10	137006	①	
125	20	137026	①	

Slat-panel with slit

Sheet steel, bottom edge with slit for electrical cable run

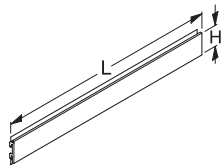

Z0168

L	H			
62.5	10	137150	①	
100	10	137154	①	
125	10	137156	①	

Slat-panel internal corner 90°

Sheet steel

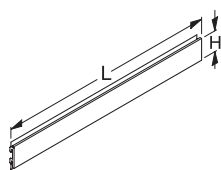

Z0170

H				
10 ¹⁾		137036	①	
10 ²⁾		137038	①	

¹⁾ right

²⁾ left

Hooks for slatted back panel walls

Blister hook

for slatted panel walls

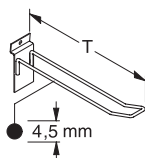

Z0210

T				
20		137910	37	
20		137910	88	
30		137912	37	
30		137912	88	

3 Back Panels and Hooks

Holder heavy type
for slatted panel walls

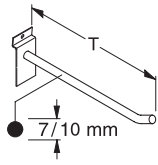

20211

Size cm		Item No.	Finish	Quantity per VE
T	∅			
20	0.7	137914	37	
20	0.7	137914	88	
30	0.7	137916	37	
30	0.7	137916	88	
40	1	137918	37	
40	1	137918	88	

3

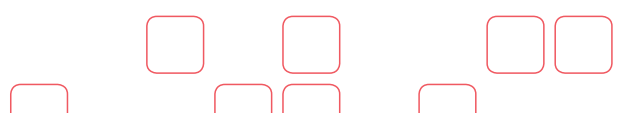

4 Shelves and Accessories

Shelves

Steel shelf

in one piece, with front and back groove

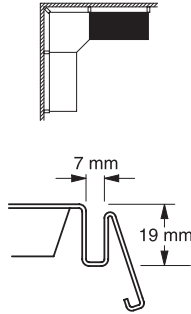
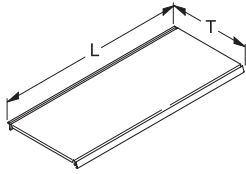

20216/22094/20217

Steel shelf, internal corner round 45°

in one piece, with front groove only

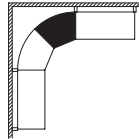
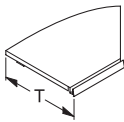

20219/22089

Steel shelf, internal corner 90°

in one piece, with front groove only. To be used with:
1 pair of brackets and
1 single bracket

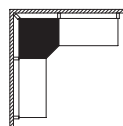
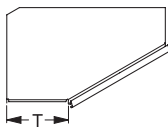

20220/22091

Steel shelf, external corner 90°

in one piece, with front groove only

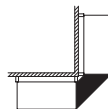
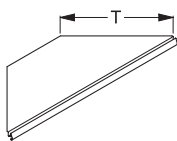

20221/22092

Size cm		Item No.	Finish	Quantity per VE
L	T			
62.5	20	145000	①	
62.5	25	145020	①	
62.5	30	145040	①	
62.5	37	140320	①	
62.5	47	140340	①	
62.5	57	140360	①	
62.5	67	140380	①	
62.5	77	140400	①	
100	20	145004	①	
100	25	145024	①	
100	30	145044	①	
100	37	141666	①	
100	47	141667	①	
100	57	141668	①	
100	67	141669	①	
100	77	141670	①	
125	20	145006	①	
125	25	145026	①	
125	30	145046	①	
125	37	141649	①	
125	47	141660	①	
125	57	141651	①	
125	67	141652	①	
125	77	141653	①	
T				
30		140594	①	
37		144368	①	
47		144369	①	
57		144370	①	
T				
30		140614	①	
37		143205	①	
47		143206	①	
57		143207	①	
T				
30		140734	①	
37		141692	①	
47		141693	①	
57		141694	①	

4 Shelves and Accessories

Steel shelf, internal corner 45°
in one piece, with front groove only

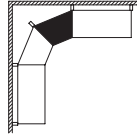
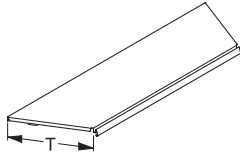

20222/22090

Size cm		Item No.	Finish	Quantity per VE
T				
30		140136	①	
37		140142	①	
47		140144	①	
57		140146	①	

Steel shelf, external corner 45°
in one piece, with front groove only. In gondolas only to be used with upright 80x30 mm

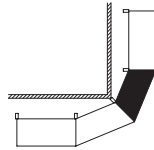
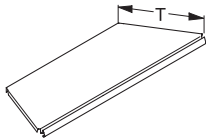

20223/22093

Size cm		Item No.	Finish	Quantity per VE
T				
30		140076	①	
37		140082	①	
47		140084	①	
57		140086	①	

Accessories for shelves

Lift-out preventers for shelf (Pair)
for preventing the steel shelves on shelf brackets from lifting out

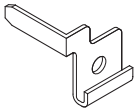

Z3639

Size cm		Item No.	Finish	Quantity per VE
		140970	37	

Filler plate
for gondolas and mobile shelving without back panels

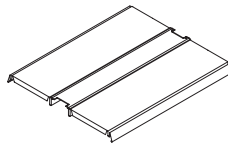
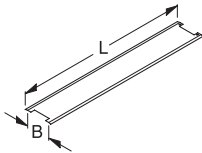

20226/20227

L	B	Item No.	Finish	Quantity per VE
100	6	141547	①	
125	6	141552	①	
100	8	143144	①	
125	8	143146	①	

Ridged rubber mat
for placing or gluing on shelf

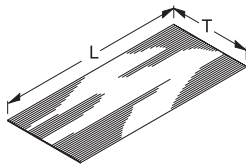

Z0266

L	T	Item No.	Finish	Quantity per VE
100	47	144184	47	
100	57	144185	47	
100	67	144186	47	
125	47	144190	47	
125	57	144191	47	
125	67	144192	47	

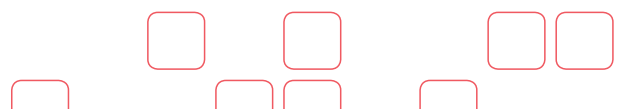

4 Shelves and Accessories

Dividing strip

Plastic, for shelf with front and back groove, transparent

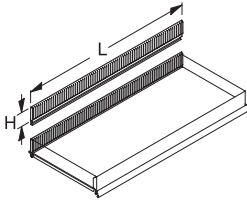

Z0238

Divider plain

Transparent plastic

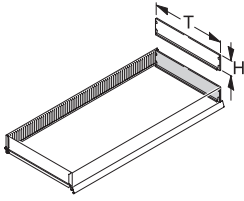

Z0239

Divider with tothing

Transparent plastic

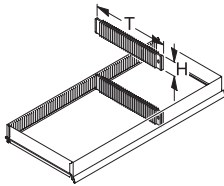

Z0240

Subdivider

for dividers with tothing. Transparent plastic

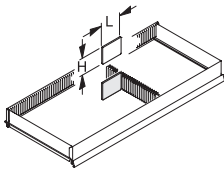

Z0241

Front glass

float glass, 6 mm thick

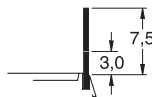
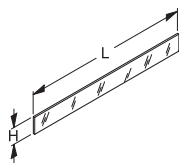

Z0242/Z0243

Size cm		Item No.	Finish	Quantity per VE
L	H			
62.5	4.5	144480	44	
62.5	7.5	144482	44	
100	4.5	144411	44	
100	7.5	144415	44	
125	4.5	144412	44	
125	7.5	144416	44	
T	H			
20	4.5	145332	44	
20	7.5	145372	44	
25	4.5	145334	44	
25	7.5	145374	44	
30	4.5	145336	44	
30	7.5	145376	44	
37	4.5	144419	44	
37	7.5	144423	44	
47	4.5	144420	44	
47	7.5	144424	44	
57	4.5	144421	44	
57	7.5	144425	44	
T	H			
20	4.5	145402	44	
20	7.5	145442	44	
25	4.5	145404	44	
25	7.5	145444	44	
30	4.5	145406	44	
30	7.5	145446	44	
37	4.5	144427	44	
37	7.5	144431	44	
47	4.5	144428	44	
47	7.5	144432	44	
57	4.5	144429	44	
57	7.5	144433	44	
L	H			
8.4	4.5	144434	44	
8.4	7.5	144435	44	
16.8	4.5	144436	44	
16.8	7.5	144437	44	
L	H			
62.5	5	143809	42	
62.5	9.5	143500	42	
100	5	143808	42	
100	9.5	143811	42	
125	5	143806	42	
125	9.5	143807	42	

4 Shelves and Accessories

Low front strip plastic

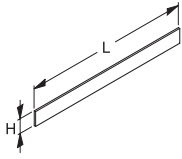

Z0245/Z0244

Size cm		Item No.	Finish	Quantity per VE
L	H			
62.5	3.5	144380	44	
100	3.5	144384	44	
125	3.5	144386	44	

Border strip H 1 for shelf with front groove, sheet steel

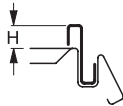
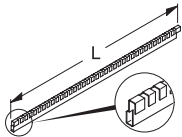

Z0246/Z0871

Size cm		Item No.	Finish	Quantity per VE
L	H			
62.5	1	143190	①	
100	1	143194	①	
125	1	143196	①	

Border strip H 5 for shelf with back groove, sheet steel

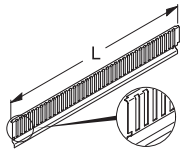

Z0247

Size cm		Item No.	Finish	Quantity per VE
L	H			
62.5	5	143189	①	
100	5	143184	①	
125	5	143186	①	

Divider sheet H 5.5 quadrant for border strips H 1 and H 5, sheet steel

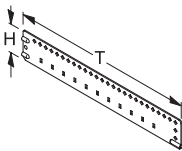

Z3208

Size cm		Item No.	Finish	Quantity per VE
T	H			
37	5.5	143640	①	
47	5.5	143641	①	
57	5.5	143642	①	
67	5.5	143643	①	

Divider sheet H 10 quadrant for border strips H 1 and H 5, sheet steel

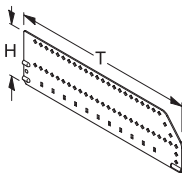

Z3209

Size cm		Item No.	Finish	Quantity per VE
T	H			
37	10	143710	①	
47	10	143711	①	
57	10	143712	①	
67	10	143713	①	

Divider sheet H 15 quadrant for border strips H 1 and H 5, sheet steel

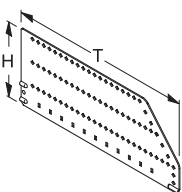

Z3210

Size cm		Item No.	Finish	Quantity per VE
T	H			
37	15	143715	①	
47	15	143716	①	
57	15	143717	①	
67	15	143718	①	

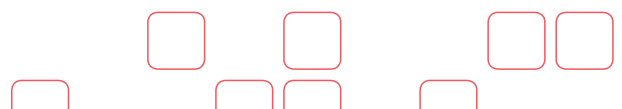

4 Shelves and Accessories

Front grid

for shelf with front and back groove
a = front grille
b = separating grille

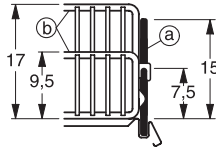
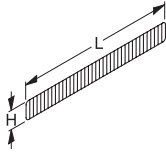

Z0255/Z0256

Size cm

Item No.

Finish

Quantity per VE

L	H			
62.5	9.5		143400	88
62.5	17		143420	88
100	9.5		144201	88
100	17		144205	88
125	9.5		144202	88
125	17		144206	88

Divider grid

to be used as a side and separating grille for wire front riser
a = front grille
b = separating grille

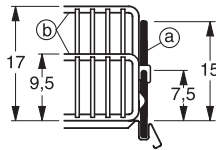
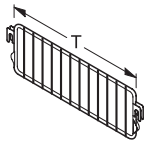

Z0257/Z0256

T	H			
37	9.5		144666	88
37	17		144670	88
47	9.5		144667	88
47	17		144671	88
57	9.5		144668	88
57	17		144672	88

Front grid (glossy zinc-plated)

for shelf with front and back groove
a = front grille
b = separating grille

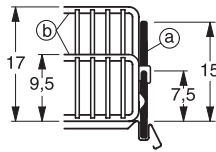
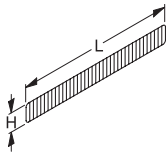

Z0255/Z0256

L	H			
62.5	9.5		143400	37
62.5	17		143420	37
100	9.5		144201	37
100	17		144205	37
125	9.5		144202	37
125	17		144206	37

Divider grid (glossy zinc-plated)

to be used as a side and separating grille for wire front riser
a = front grille
b = separating grille

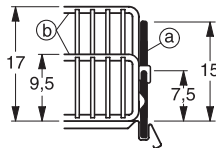
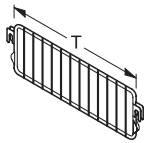

Z0257/Z0256

T	H			
37	9.5		144666	37
37	17		144670	37
47	9.5		144667	37
47	17		144671	37
57	9.5		144668	37
57	17		144672	37

Scanning ticket strips

Scanning ticket strip H 4

Plastic, for clipping on shelves or on scanning frames

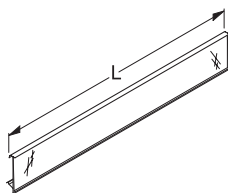

Z0267/Z0268

L	H			
62.5	4		144840	② 10
100	4		144844	② 10
125	4		144846	② 10

4 Shelves and Accessories

Scanning ticket strip H 4 for grid shelves

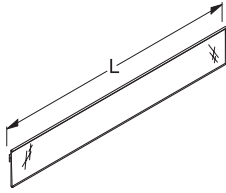

Z0269/Z0270

Insertion hook for the scanning ticket strip for grid shelves

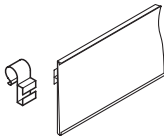

Z0271

Scanning frame

Scanning frame Sheet steel, adjustable

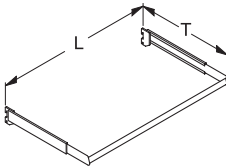

Z0272

Size cm		Item No.	Finish	Quantity per VE
L				
100		144254	②	
125		144256	②	

Size cm		Item No.	Finish	Quantity per VE
		144260	②	10

L	T	Item No.	Finish	Quantity per VE
100	35 ²⁾	144054	①	
125	35 ²⁾	144056	①	

¹⁾ Adjustment range T 20–30 cm ²⁾ Adjustment range T 35–55 cm



5 Special Parts

Fascias and accessories

Fascia bracket H 20

Sheet steel, for fascias H 20 and fascias H 20 with cutout.
Also usable with wooden fascias

Note: If special colours are ordered the bracket is jura white.

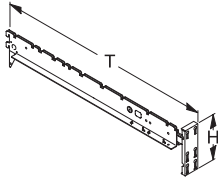

Z0284

Fascia H 20

Sheet steel

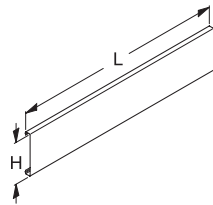

Z0285

Fascia return H 20

Sheet steel. For use on left and right side

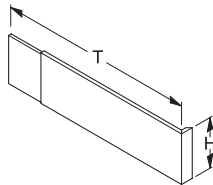

Z0294

Bracket for fascia return

Sheet steel. For use on left and right side

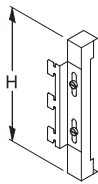

Z0839

Lower soffit, straight

Sheet steel, suitable for lighting unit

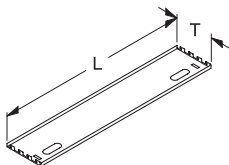

Z0298

Size cm		Item No.	Finish	Quantity per VE
T	H			
53-59 ¹⁾	20	150406	①	
63-69 ²⁾	20	150408	①	
¹⁾ To cover: use back panel H 30				
²⁾ To cover: use back panel H 40				
L	H			
62.5	20	151500	①	
100	20	154633	①	
125	20	154634	①	
T	H			
61-76	20	154640	①	
H				
20		150810	①	
L	T			
62.5	20	132263	①	
100	20	132282	①	
125	20	132292	①	

5 Special Parts

Lower soffit, straight, T 20

Sheet steel without holes

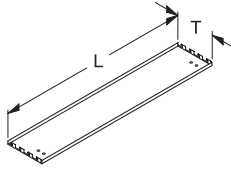

Z0850

Lower soffit, shaped

Sheet steel, suitable for lighting unit
For fascia H 20 and for fascia H 20 with cutout

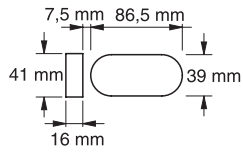
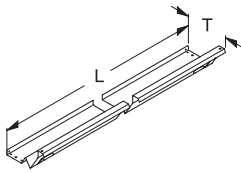

Z0299/Z0300

Size cm		Item No.	Finish	Quantity per VE
L	T			
100	20	139464	①	
125	20	139466	①	

Size cm		Item No.	Finish	Quantity per VE
L	T			
100	20	152324	①	
125	20	152326	①	

Perforated rear support bar 50×20 mm

Rear support bar 50×20 mm

perforated, made of tubular steel 50×20 mm

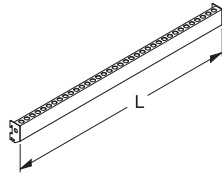

Z0336

Size cm		Item No.	Finish	Quantity per VE
L	T			
62.5		153520	①	
100		154764	①	
125		154765	①	

Holders for perforated rear support bar

Separator, without plate

for hanging into perforated rear support bar 50×20 mm

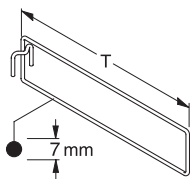

Z0340

Size cm		Item No.	Finish	Quantity per VE
T	L			
42		155043	37	88

Separator, with plate

for hanging into perforated rear support bar 50×20 mm Plate for description of goods

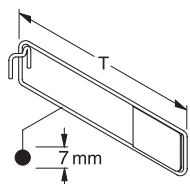

Z0341

Size cm		Item No.	Finish	Quantity per VE
T	L			
42		155044	37	88



5 Special Parts

Hook-on bracket

suitable for perforated rear support bar 50x20 mm and support frame

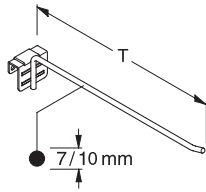

Z3700

Size cm

Item No.

Finish

Quantity per VE

T	∅				
20	0.7		151889	37	50
20	0.7		151889	88	
25	0.7		151890	37	50
25	0.7		151890	88	
30	0.7		151891	37	50
30	0.7		151891	88	
40	1		151439	37	50
40	1		151439	88	

Bar hook with end plate

suitable for rear support bar 50x20 mm

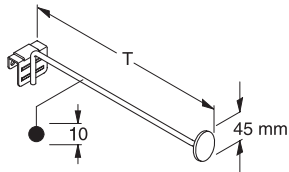

Z4274

T	∅				
25	1		151532	37	88
40	1		151579	37	88

Tool holder

suitable for perforated rear support bar 50x20 mm

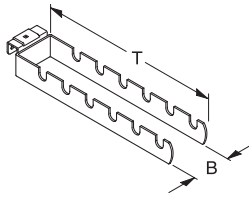

Z0350

T	B				
30	6		153686	37	88

Blister hook

suitable for perforated rear support bar 50x20 mm

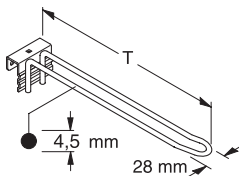

Z0352

T					
20			153672	37	25
20			153672	88	
30			153674	37	25
30			153674	88	

Single prong hook with label holder

suitable for rear support bar 50x20 mm, perforated; for label pocket

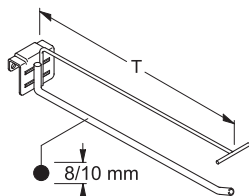

Z1850

T	∅				
45	0.8		158916	37	88
45	1		158918	37	88

5 Special Parts

Special parts for textiles

Clothes frame, straight

oval tube, chrome-plated 30x15 mm

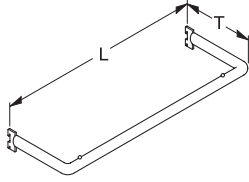

Z0415

Size cm		Item No.	Finish	Quantity per VE
L	T			
100	25	152884	38	
100	35	152894	38	
125	25	152886	38	
125	35	152896	38	

Gondola end frame

Connection bars for gondola end frame (Pair)

for screwing up on gondola uprights

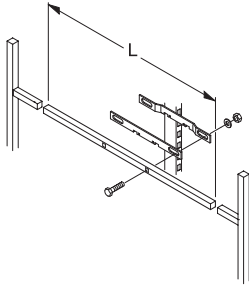

Z0469

L				
100		155104	①	
125		155106	①	

Uprights for gondola end frame (Pair)

Tubular section 30x30 mm; complete with tube insert and foot disk.
Can optionally be fitted on one or both sides with back panels

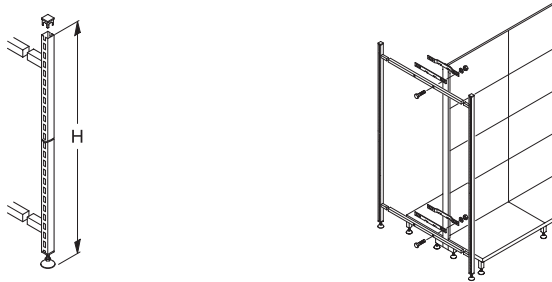

Z0470/Z0471

H				
120		155128	①	
140		155132	①	
160		155136	①	
180		155140	①	
200		155144	①	
220		155148	①	
240		155152	①	



6 Wire Articles

Wire articles and accessories

Grid shelf, close meshed with price ticket holder

Suitable for brackets 2 H, brackets 3 H, heavy brackets and for baselegs. Welded profile in front for ticket strip.

Mesh size approx. 15 mm. Wire Ø 3 mm

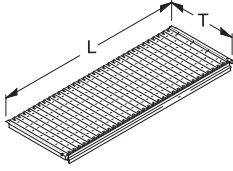

Z0955

Size cm		Item No.	Finish	Quantity per VE
L	T			
100	37	169212	①	
100	47	169217	①	
100	57	169182	①	
125	37	169213	①	
125	47	169218	①	
125	57	169183	①	

TEK wire basket

to fit on shelf brackets or on baselegs. Mesh size approx. 20 mm

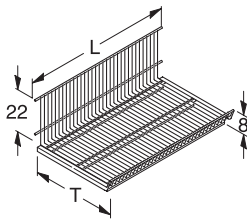

Z0969

L	T	H	Item No.	Finish	Quantity per VE
100	37	22	160344	①	
100	47	22	160354	①	
100	57	22	160364	①	
125	37	22	160346	①	
125	47	22	160356	①	
125	57	22	160366	①	

Divider for TEK wire baskets

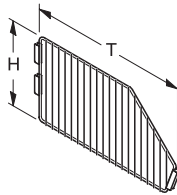

Z0949

T	H	Item No.	Finish	Quantity per VE
37	22	160382	①	
47	22	160384	①	
57	22	160386	①	

Scanning ticket strip H 4 TEK

to fit on TEK wire baskets. Plastic

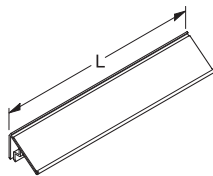

Z0968

L	H	Item No.	Finish	Quantity per VE
100	4	144244	②	
125	4	144246	②	

Grid shelf with front and back groove

front and back groove made of sheet steel, mesh size approx. 11 mm

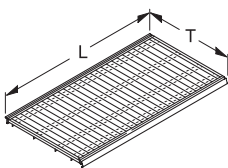

Z3372/Z3472

L	T	Item No.	Finish	Quantity per VE
62.5	37	160940	①	
62.5	47	160945	①	
62.5	57	160950	①	
100	37	160942	①	
100	47	160947	①	
100	57	160952	①	
125	37	160943	①	
125	47	160948	①	
125	57	160953	①	

6 Wire Articles

Grid shelf PBE

can be used with folded up edge H 15 at rear or front.
Mesh size approx. 11 mm

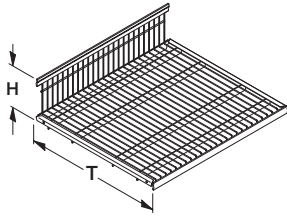

Z3649

Scanning ticket strip H 4 PBE PKE

plastic, for attaching to PBE grid shelf and PKE wire basket

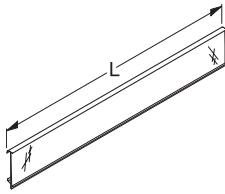

Z3838/Z3837



Back wire grating

for suspension in front of uprights, mesh width appr. 50x50 mm

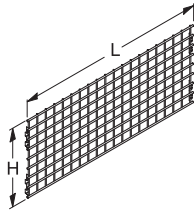

Z0500

Size cm			Item No.	Finish	Quantity per VE
L	T	H			
62.5	37	15	160010	①	
62.5	47	15	160020	①	
62.5	57	15	160030	①	
100	37	15	160014	①	
100	47	15	160024	①	
100	57	15	160034	①	
125	37	15	160016	①	
125	47	15	160026	①	
125	57	15	160036	①	

L	H			
62.5	4	144060	②	
100	4	144062	②	
125	4	144063	②	

L	H			
100	40	160504	①	
125	40	160506	①	



TegoTwo-in-One



TegoTwo-in-One Components Overview

TegoTwo-in-One without SB integration

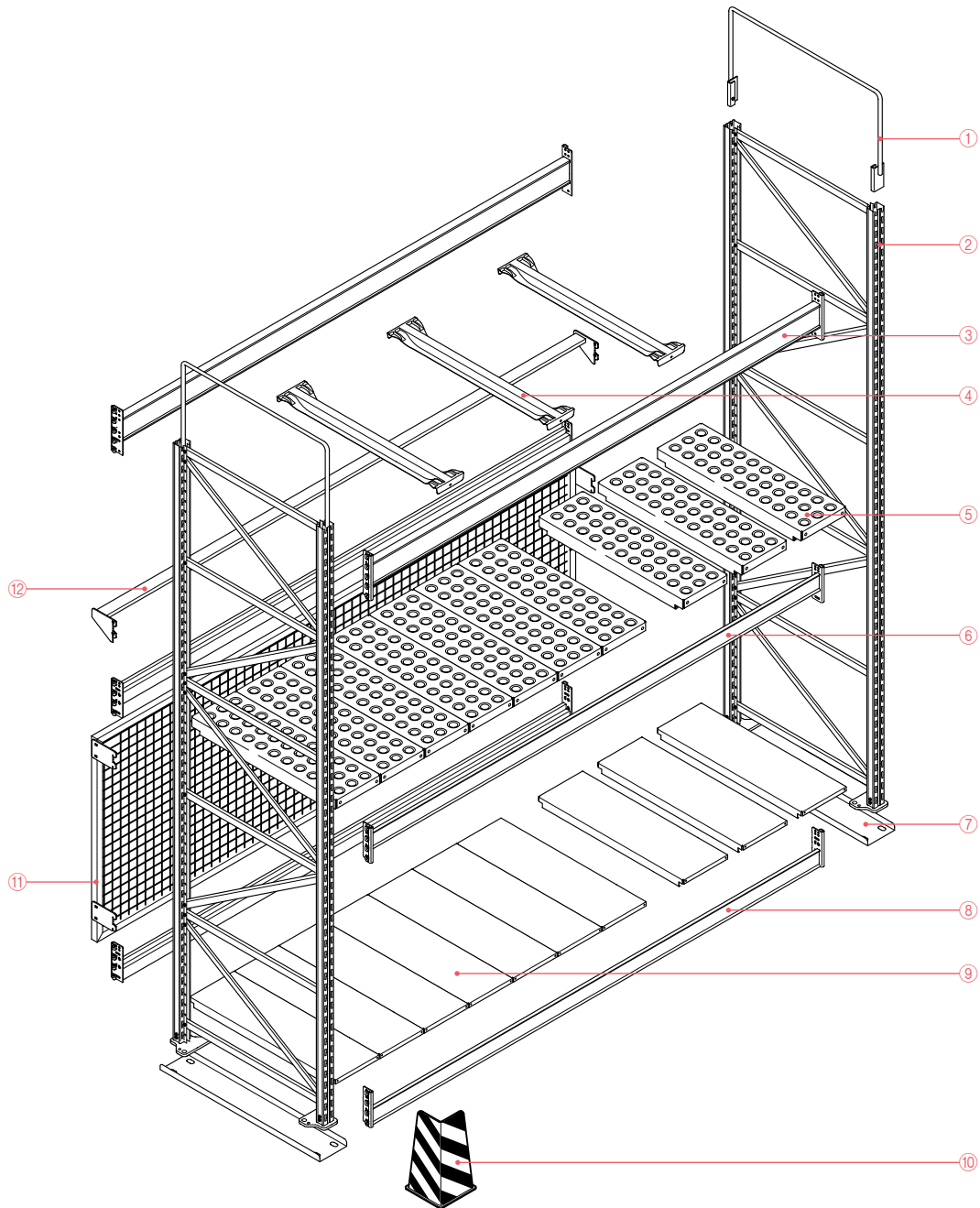

24282

①	Tow bow	➔ 82
②	Unscrewed stand	➔ 69
③	Traverse centre ITDL	➔ 73
④	FO depth connector	➔ 78
⑤	Perforated ARP shelf	➔ 79
⑥	Traverse centre ARPL	➔ 73
⑦	Load distribution shoe	➔ 83
⑧	Traverse bottom ARPL	➔ 76
⑨	Shelving element ARP	➔ 79
⑩	Bumper (corner)	➔ 83
⑪	Back grating H 100	➔ 82
⑫	Push-through guard T 4	➔ 82

TegoTwo-in-One Components Overview

TegoTwo-in-One with SB integration

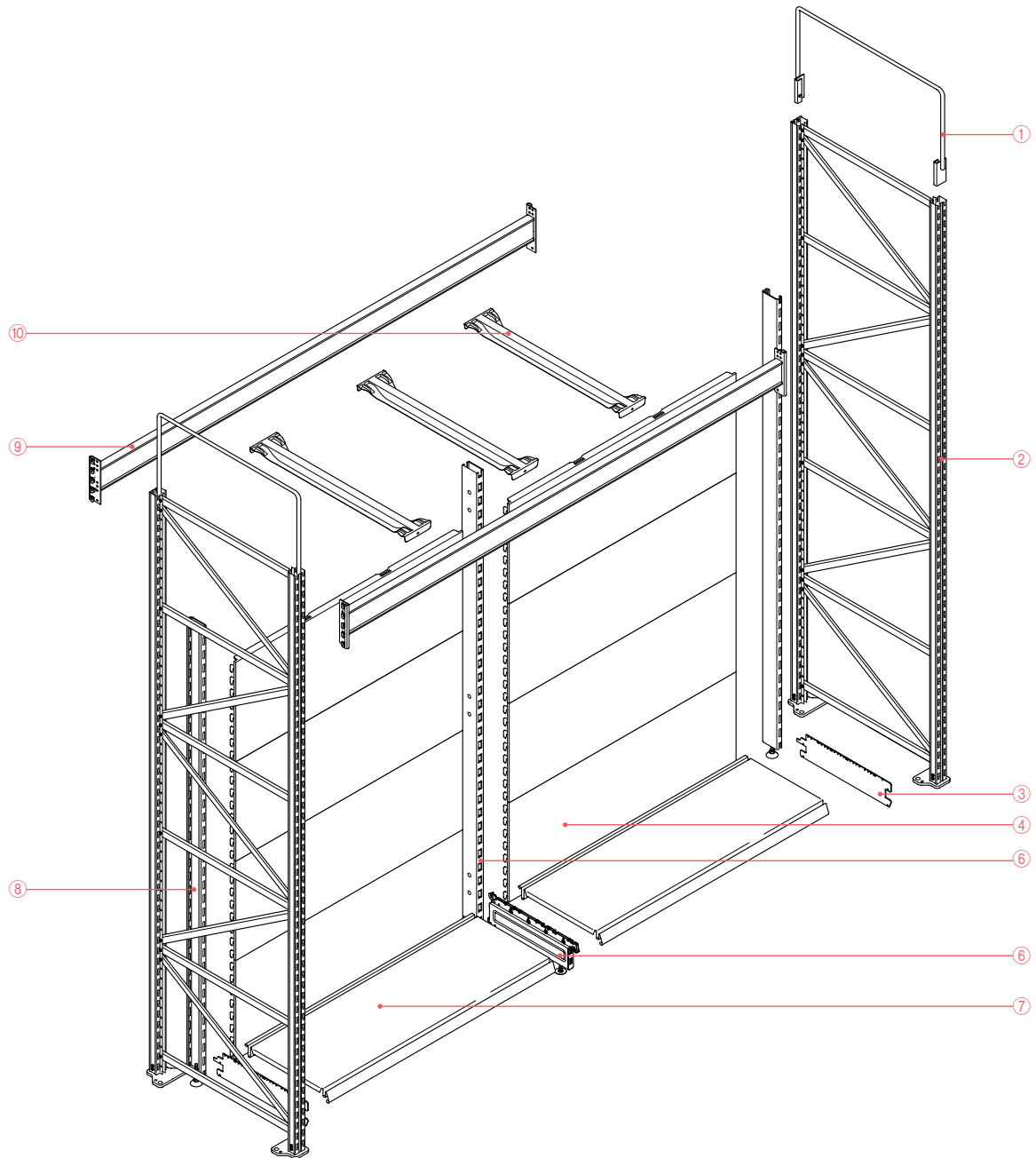

Z4283

①	Tow bow	➔ 82
②	Unscrewed stand,	➔ 69
③	Single bearer	➔ 85
④	Back panel	➔ 36
⑤	Upright 80x30 mm	➔ 85
⑥	Baseleg H 16	➔ 31, 85
⑦	Steel shelf	➔ 45
⑧	Screw-on section 80x22.5 mm	➔ 70
⑨	Traverse centre ITDL	➔ 74
⑩	FO depth connector	➔ 78

TegoTwo-in-One Technical Information

Colour and finish code / Order information

Colour code standard colours

01	Plastic white
24	Jura white, similar to RAL 9001
66	Light grey, RAL 7035
88	White aluminium, RAL 9006



Standard colour group code

- ① Standard colours 24, 66, 88
- ② Standard colours 01, 66, 88

Finish code

01	Plastic white		01
02	Black		02
12	Gentian violet, RAL 5010		12
17	Flame red, RAL 3000		17
23	Pure white, RAL 9010		23
24	Jura white, similar to RAL 9001		24
28	Rape yellow, RAL 1021		28
35	Yellow / Black		35
51	zinc galvanized		51
66	Light grey, RAL 7035		66
67	Silver grey, RAL 7001		67
68	Jet black, RAL 9005		68
71	Slate grey, RAL 7015		71
86	Anthracite grey, RAL 7016		86
87	Grey aluminium, RAL 9007		87
88	White aluminium, RAL 9006		88

Special coating

- 37 zinc plated, glossy (galvanized)
- 38 chrome-plated
- 41 hot-dip galvanized

Note

The colour samples show only the colour shade, not the quality of the surface of the respective product!
Slight colour differences are possible for technical reasons. These are not deemed to be defects. Our previous colour charts are hereby invalid.

Special colours

Other special colours are available on request.
On ordering, we add a surcharge of EUR 25.- for each special colour.

Order information

Composition of item numbers

Example:
Load distribution shoe CG 55x40, hot-dip galvanized = 206682 41

206682 41 = Item group
206682 41 = Item basic number
206682 41 = Finish code

Order example

Shelving element ARP, T 90 cm, B 18.7 cm, in special colour rape yellow (RAL 1021)
Item number **207003** and required colour:
Rape yellow (RAL 1021) = Finish code **28**

To place this order, the item number must be: **207003 28**.

TegoTwo-in-One Technical Information

System sizes / Stand sizes / Chipboard sizes

System sizes system CG 55x40

Upright cross-section and foot plate
(all figures in mm)

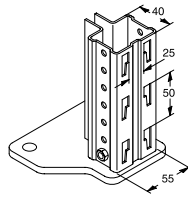

Z4077

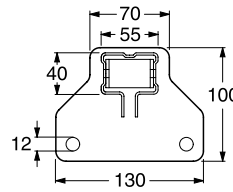

Z4078

Stand depth (T) CG 55x40	
T 60	567 mm
T 70	667 mm
T 80	767 mm
T 95	934 mm
T 115	1134 mm
T 135	1334 mm
T 155	1534 mm

System sizes system CG 70x80

Upright cross-section and foot plate
(all figures in mm)

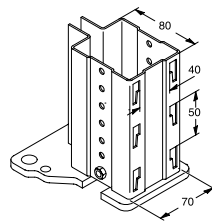

Z4115

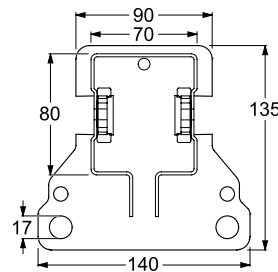

Z4116

Stand depth (T) CG 70x80	
T 85	857 mm
T 105	1057 mm
T 115	1157 mm

Stand sizes

L: axis spacing
LM: clearance
T: stand depth

System CG 55x40

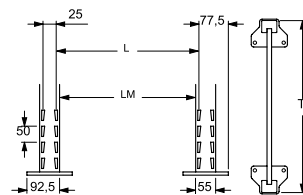

Z1908

System CG 70x80

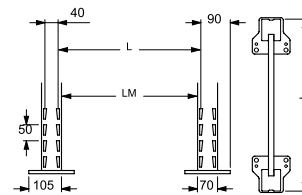

Z1909

Axis spacing L in cm	Clearance LM in cm
L 125	122.0
L 133	130.3
L 200	197.0
L 250	247.0
L 266	263.6
L 300	297.0

TegoTwo-in-One Technical Information

Chipboard dimensions / Number of elements and load capacity for shelving elements and perforated shelves

Chipboard sizes for FO depth connectors recessed (for system CG 55×40 and CG 70×80)

When using FO recessed depth connectors in conjunction with 40 mm wide traverses

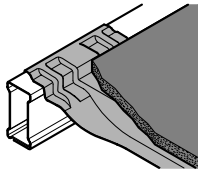

Z4075

Chipboard length (FO depth connectors, recessed) System CG 55×40 and System CG 70×80	
Axis spacing in cm	Chipboard length in cm
L 125	122.0
L 133	130.3
L 200	197.0
L 250	247.0
L 266	263.6
L 300	297.0

Chipboard width (FO depth connectors, recessed) System CG 55×40 Traverses 40 mm wide	
Shelving depth T in cm	Chipboard width in cm
T 80	66.4
T 115	103.1

Chipboard width (FO depth connectors, recessed) System CG 70×80 Traverses 40 mm wide	
Shelving depth T in cm	Chipboard width in cm
T 85	75.4
T 105	95.4
T 115	105.4

Chipboard sizes (traverse ARPL)

when using traverses ARPL

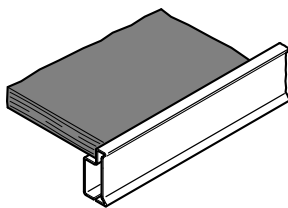

Z3942

Chipboard length (traverse ARPL) System CG 55×40 and System CG 70×80	
Axis spacing in cm	Chipboard length in cm
L 125	120.0
L 133	128.5
L 200	195.0
L 250	245.0
L 266	261.5
L 300	295.0

Chipboard width (traverse ARPL) System CG 55×40	
Shelving depth T in cm	Chipboard width in cm
T 60	53.3
T 70	63.3
T 80	73.3
T 95	90.0
T 115	110.0
T 135	130.0
T 155	150.0

Chipboard width (traverse ARPL) System CG 70×80	
Shelving depth T in cm	Chipboard width in cm
T 85	82.3
T 105	102.3
T 115	112.3

Number of elements and load capacity for shelving elements ARP and perforated ARP shelves in conjunction with traverses ARPL 60×40 and 80×40

Shelving elements in steel are available in widths 18.7 cm and 22.6 cm.
When fitting shelving compartments with these shelves we recommend using the following combinations:

Number of shelves		
Axis spacing in cm	Shelf width 18.7 cm [No. of shelves]	Shelf width 22.6 cm [No. of shelves]
L 125	4	2
L 133	2	4
L 200	8	2
L 250	1	10
L 266	14	0
L 300	0	13

Load capacity per shelving element ARP (up to max. T 115): **350 kg**.
Load capacity per perforated ARP shelf (up to max. T 105): **60 kg**.

TegoTwo-in-One Technical Information

Permissible loads

Conditions Traverses

- Specified bay loads presuppose an evenly distributed load over the entire pair of traverses or shelf.
- The maximum permissible central deflection is max. L/200 of the traverse length.
- The specified compartment load applies only in conjunction with our TegoTwo-in-One shelving.
- Traverses ITDL and ARPL must not be loaded to torsion (see figures).

Right

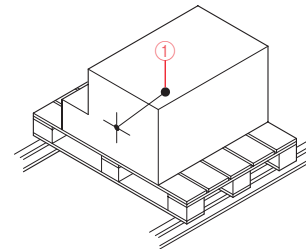

① Load centre

Z3654

Wrong

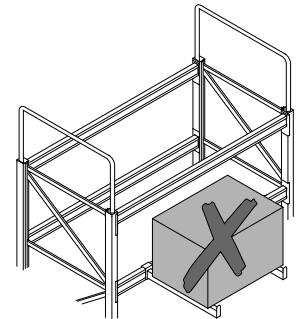

Z2355

Stand requirements

- The shelving must not be subjected to loads under impact.
- The specified permissible loads are applicable with at least four shelving bays per row.
- For sufficient longitudinal stability, at least 2 pairs of traverses must be suspended per shelving bay.
- Shelving must be set up on concrete floors with sufficient dimensions (minimum concrete quality C20/25 in accordance with EN 1992).
- Floor evenness, irrespective of whether finished or unfinished, must comply with DIN 18202, part 5.
- Shelving stands must be permanently dowelled to the concrete floor.
- For system CG 55×40 2 straddling bolts M 8 per stand foot disc.
- For system CG 70×80 1 straddling bolt M 10 per stand foot disc.

- When planning and installing TegoTwo-in-One shelving, always note and comply with the instructions for installation and use as well as national and international standards and regulations. Please request instructions for installation and use if necessary.
- Assembly and installation may only be performed by authorized installation personnel.
- If no load information is available or special load requirements exist, please contact our technical department.
- When determining permissible load values for the shelving bay, base your calculation on the greatest bay height in each case.
- In the case of shelving with less than four shelving bays, the bay load must be reduced using the following formula:

Bay load for 3 bays	= 0.88 × bay load for 4 bays
Bay load for 2 bays	= 0.77 × bay load for 4 bays
Bay load for 1 bay	= 0.66 × bay load for 4 bays

Permissible load per pair of traverses in kg, System CG 55×40 and System CG 70×80

Permissible load per pair of traverses in kg (System CG 55×40 and System CG 70×80)						
Traverse with weld-on position above and below						
Axis spacing in cm	ARPL 60×40	ARPL 80×40	ITDL 80×40	ITDL 100×40	ITDL 120×40	ITDL 130×40
L 125	800	2100	2100	2900	4500	4500
L 133	800	2100	2100	2900	4500	4500
L 200	480	1300	1200	1900	3100	4500
L 250	340	950	800	1500	2100	3600
L 266	300	850	700	1300	1900	3100
L 300	260	700	600	1100	1600	2600

TegoTwo-in-One Technical Information

Permissible loads

Permissible load per pair of traverses in kg (System CG 55×40 and System CG 70×80)						
Traverse with weld-on central position						
Axis spacing in cm	ARPL 60×40	ARPL 80×40	ITDL 80×40	ITDL 100×40	ITDL 120×40	ITDL 130×40
L 125	1000	2100	2100	2900	4500	4500
L 133	1000	2100	2100	2900	4500	4500
L 200	800	1400	1400	1900	3500	4500
L 250	550	1070	1200	1600	2600	3600
L 266	460	950	1100	1500	2300	3200
L 300	400	750	900	1200	1900	2600

Permissible bay load for TegoTwo-in-One – System CG 55×40 without SB integration and System CG 70×80 without SB integration

Applicable up to a shelving depth of
 T = 155 cm (system CG 55×40) and
 T = 115 cm (system CG 70×80)

Permissible bay load in kg		
Compartment height F	System CG 55×40 in combination with traverses ITDL 80×40, ITDL 100×40 and ARPL 80×40	System CG 70×80 in combination with traverses ITDL 120×40 and ITDL 130×40
75 cm	5200	16200
100 cm	4060	14200
125 cm	2980	12000
150 cm	1980	9800
175 cm	1880	8200
200 cm	1720	7000
225 cm	—	6000
250 cm	—	5000

TegoTwo-in-One – System CG 55×40 with SB integration and System CG 70×80 with SB integration

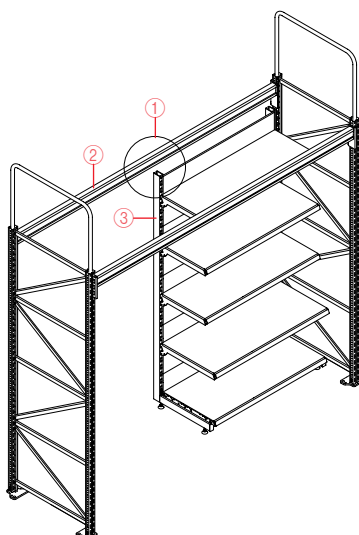

- ① There must **not** be any connection between the upright of the SB integration and the traverse above it.
- ② Traverse of the TegoTwo-in-One shelving
- ③ Upright of the SB integration

TegoTwo-in-One Technical Information

Permissible loads

TegoTwo-in-One – permissible bay load for System CG 55×40 with SB integration

Permissible bay load up to a shelving depth T = 155 cm.
 Applicable in combination with traverse type ITDL 80×40, ITDL 100×40 and ARPL 80×40.
 Do not use plug-on parts for central upright of SB integration (see figure “TegoTwo-in-One – System CG 55×40 with SB integration and System CG 70×80 with SB integration” on page 64).

Permissible bay load in kg			
TegoTwo-in-One – System CG 55×40 with SB integration in combination with traverses ITDL 80×40, ITDL 100×40 and ARPL 80×40			
Compartment height F above lowest pair of traverses	Integration height		
	H = 200 cm	H = 220 cm	H = 240 cm
max. up to 160 cm	1220	960	810

TegoTwo-in-One – permissible bay load for System CG 70×80 with SB integration

Do not use plug-on parts for central upright of SB integration (see figure “TegoTwo-in-One – System CG 55×40 with SB integration and System CG 70×80 with SB integration” on page 64).
 Permissible bay load up to a shelving depth T = 155 cm.

Permissible bay load in kg			
TegoTwo-in-One – System CG 70×80 with SB integration in combination with traverses ITDL 120×40 and ITDL 130×40			
Compartment height F above lowest pair of traverses	Integration height		
	H = 220 cm	H = 240 cm	H = 260 cm
up to 75 cm	8500	7000	6200
100 cm	8000	6800	6000
125 cm	7500	6500	5700
150 cm	7200	6400	5600
175 cm	6900	6200	5400
200 cm	6700	6000	5300
225 cm	6500	5900	5200
250 cm	6400	5800	5100

Permissible load per depth connector

Permissible load per FO depth connector and FO depth connector recessed		
Stand depth	FO depth connector	FO depth connector recessed
T = 80 cm	660 kg	440 kg
T = 85 cm	650 kg	440 kg
T = 105 cm	490 kg	440 kg
T = 115 cm	440 kg	440 kg

Permissible load per shelving element ARP

The permissible load per shelving element ARP is **350 kg**; applicable in conjunction with traverse ARPL 60×40 and 80×40 and with maximum stand depth T = 115 cm.

Permissible load per perforated ARP shelf

The permissible load per perforated ARP shelf is **60 kg**; applicable in conjunction with traverse ARPL 60×40 and 80×40 and with maximum stand depth T = 105 cm.

TegoTwo-in-One Technical Information

Example calculations of the permissible bay and compartment loads, TegoTwo-in-One – System CG 55x40

Determination of the permissible compartment and bay loads for TegoTwo-in-One – System CG 55 x 40 without SB integration in combination with traverse type 80 x 40

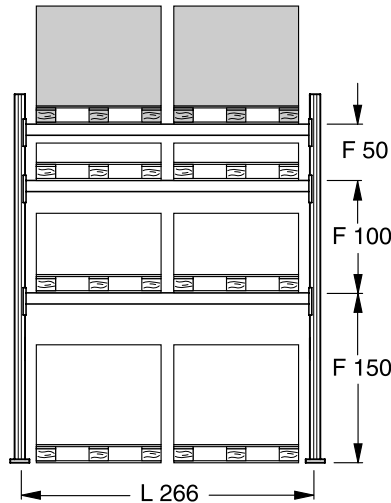

Z4079

Determination of the permissible compartment and bay loads for TegoTwo-in-One – System CG 55 x 40 with SB integration in combination with traverse type 80 x 40

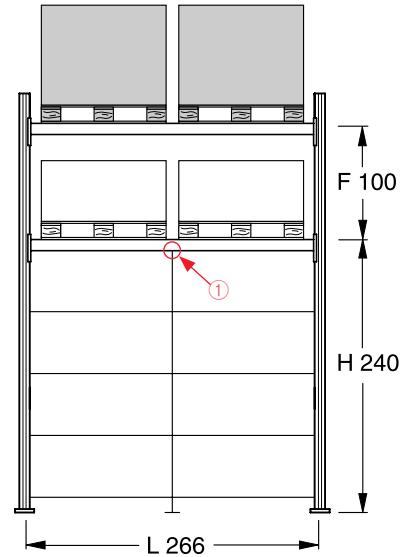

Z4080

① do **not** use plug-on parts for central upright of SB integration

Note

The lowest pair of traverses must always be executed together with the central pair of traverses.

TegoTwo-in-One – System CG 55x40 without SB integration

Determination of permissible bay load:

When determining the permissible bay load, the biggest compartment height is always taken as a basis.

Permissible bay load = **1980 kg**.

Determination of permissible load per pair of traverses:

Permissible load per pair of traverses ITDL centre 80x40 with an axis spacing (L) of 266 cm = **1100 kg**.

Determination of pro-rated compartment load:

The shelving system has 3 shelves per bay.

The pro-rated compartment load is consequently:

$$\text{Com-partment load} = \frac{\text{Permissible bay load}}{\text{Number of shelves per bay}} = \frac{1980 \text{ kg}}{3} = \mathbf{660 \text{ kg}}$$

Permissible compartment load:

Important:

The compartment load is compared to the permissible load per pair of traverses. The permissible compartment load then always results from the **smaller** of the two values:

- Permissible load per pair of traverses ITDL 80x40 centre = **1100 kg** (with axis spacing L 266 cm)
- Compartment load = **660 kg**

Permissible compartment load: 660 kg

The **pro-rated compartment load** with **660 kg** is **smaller** than the permissible load per pair of traverses ITDL centre 80x40 with 1100 kg and is therefore the relevant value for the permissible compartment load.

TegoTwo-in-One – System CG 55x40 with SB integration

Determination of permissible bay load:

When determining permissible bay loads, always base your calculation on the compartment height over the lowest pair of traverses.

Permissible bay load = **810 kg**.

Determination of permissible load per pair of traverses:

Permissible load per pair of traverses ITDL centre 80x40 with an axis spacing (L) of 266 cm = **1100 kg**.

Determination of pro-rated compartment load:

The shelving system has 2 shelves per bay.

The pro-rated compartment load is consequently:

$$\text{Com-partment load} = \frac{\text{Permissible bay load}}{\text{Number of shelves per bay}} = \frac{810 \text{ kg}}{2} = \mathbf{405 \text{ kg}}$$

Permissible compartment load:

Important:

The compartment load is compared to the permissible load per pair of traverses. The permissible compartment load then always results from the **smaller** of the two values:

- Permissible load per pair of traverses ITDL 80x40 centre = **1100 kg** (with axis spacing L 266 cm)
- Compartment load = **405 kg**

Permissible compartment load: 405 kg

The **pro-rated compartment load** with **405 kg** is **smaller** than the permissible load per pair of traverses ITDL centre 80x40 with 1100 kg and is therefore the relevant value for the permissible compartment load.

TegoTwo-in-One Technical Information

Example calculations of the permissible bay and compartment loads, TegoTwo-in-One – System CG 70×80

Determination of the permissible compartment and bay loads for TegoTwo-in-One – System CG 70×80 without SB integration in combination with traverse type 130×40

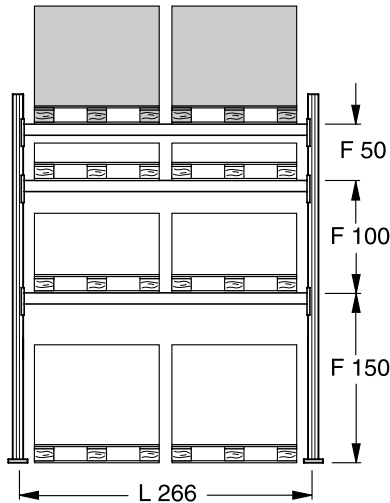

Z4079

TegoTwo-in-One – System CG 70×80 without SB integration

Determination of permissible bay load:

When determining the permissible bay load, the biggest compartment height is always taken as a basis.

Permissible bay load = **9800 kg**.

Determination of permissible load per pair of traverses:

Permissible load per pair of traverses ITDL centre 130×40 with an axis spacing (L) of 266 cm = **3200 kg**.

Determination of pro-rated compartment load:

The shelving system has 3 shelves per bay.

The pro-rated compartment load is consequently:

$$\text{Com-partment load} = \frac{\text{Permissible bay load}}{\text{Number of shelves per bay}} = \frac{9800 \text{ kg}}{3} = \mathbf{3267 \text{ kg}}$$

Permissible compartment load:

Important:

The compartment load is compared to the permissible load per pair of traverses. The permissible compartment load then always results from the **smaller** of the two values:

- Permissible load per pair of traverses ITDL 130×40 centre = **3200 kg** (with axis spacing L 266 cm)
- Compartment load = **3267 kg**

Permissible compartment load: 3200 kg.

The permissible **load per pair of traverses** centre ITDL 130×40 with **3200 kg** is **smaller** than the pro-rated compartment load with 3267 kg and is therefore the relevant value for the permissible compartment load.

Determination of the permissible compartment and bay loads for TegoTwo-in-One – System CG 70×80 with SB integration in combination with traverse type 130×40

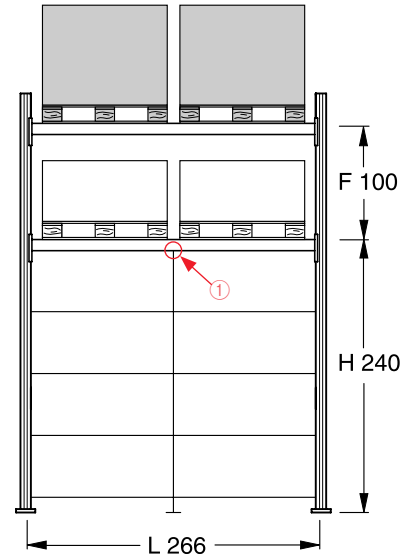

Z4080

① do **not** use plug-on parts for central upright of SB integration

Note

The lowest pair of traverses must always be executed together with the central pair of traverses.

TegoTwo-in-One – System CG 70×80 with SB integration

Determination of permissible bay load:

When determining permissible bay loads, always base your calculation on the compartment height over the lowest pair of traverses.

Permissible bay load = **8000 kg**.

Determination of permissible load per pair of traverses:

Permissible load per pair of traverses ITDL centre 130×40 with an axis spacing (L) of 266 cm = **3200 kg**.

Determination of pro-rated compartment load:

The shelving system has 2 shelves per bay.

The pro-rated compartment load is consequently:

$$\text{Com-partment load} = \frac{\text{Permissible bay load}}{\text{Number of shelves per bay}} = \frac{8000 \text{ kg}}{2} = \mathbf{4000 \text{ kg}}$$

Permissible compartment load:

Important:

The compartment load is compared to the permissible load per pair of traverses. The permissible compartment load then always results from the **smaller** of the two values:

- Permissible load per pair of traverses ITDL 130×40 centre = **3200 kg** (with axis spacing L 266 cm)
- Compartment load = **4000 kg**

Permissible compartment load: 3200 kg.

The permissible **load per pair of traverses** centre ITDL 130×40 with **3200 kg** is **smaller** than the pro-rated compartment load with 4000 kg and is therefore the relevant value for the permissible compartment load.



*Nothing is
too large or
too heavy
for us.*

A Stands

Stands for TegoTwo-in-One, screwed type

Unscrewed stand, CG 55x40

made of C-profile 55x40 mm (screws included).
Not assembled



Z1336

Unscrewed stand, CG 55x40 for integration on both sides

made of C-profile 55x40 mm (screws included), suitable for screw-on section 80x22.5 mm.
Not assembled

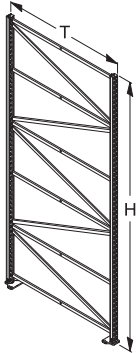

Z1337

Screw-on section 80x22.5 mm

with foot disk, suitable for stand CG 55x40 with stand heights 220 cm, 260 cm, 300 cm and 340 cm, for integration in front

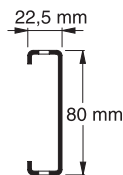

Z1111/Z1371

Size cm		Item No.	Finish	Quantity per VE
T	H			
60 ¹⁾	220	298021	①	51
60 ¹⁾	260	298061	①	51
60 ¹⁾	300	298101	①	51
60 ¹⁾	340	298141	①	51
70 ²⁾	220	298022	①	51
70 ²⁾	260	298062	①	51
70 ²⁾	300	298102	①	51
70 ²⁾	340	298142	①	51
80 ³⁾	220	298023	①	51
80 ³⁾	260	298063	①	51
80 ³⁾	300	298103	①	51
80 ³⁾	340	298143	①	51

¹⁾ for integrated single bearer for baseleg T 47

²⁾ for integrated single bearer for baseleg T 57

³⁾ for integrated single bearer for baseleg T 67

Size cm		Item No.	Finish	Quantity per VE
T	H			
95 ¹⁾	220	298024	①	51
95 ¹⁾	260	298064	①	51
95 ¹⁾	300	298104	①	51
95 ¹⁾	340	298144	①	51
115 ²⁾	220	298026	①	51
115 ²⁾	260	298066	①	51
115 ²⁾	300	298106	①	51
115 ²⁾	340	298146	①	51
135 ³⁾	220	298027	①	51
135 ³⁾	260	298067	①	51
135 ³⁾	300	298107	①	51
135 ³⁾	340	298147	①	51
155 ⁴⁾	220	298028	①	51
155 ⁴⁾	260	298068	①	51
155 ⁴⁾	300	298108	①	51
155 ⁴⁾	340	298148	①	51

¹⁾ for integrated single bearer on both sides for baseleg T 37

²⁾ for integrated single bearer on both sides for baseleg T 47

³⁾ for integrated single bearer on both sides for baseleg T 57

⁴⁾ for integrated single bearer on both sides for baseleg T 67

Size cm	Item No.	Finish	Quantity per VE
H			
215 ¹⁾	290402	①	
255 ²⁾	290406	①	
295 ³⁾	290410	①	
335 ⁴⁾	290414	①	

¹⁾ suitable for stand height 220 cm

²⁾ suitable for stand height 260 cm

³⁾ suitable for stand height 300 cm

⁴⁾ suitable for stand height 340 cm

A Stands

Screw-on section 80x22.5 mm

with foot disk, suitable for stand CG 55x40 with stand heights 200 cm, 220 cm and 240 cm, for integration in front

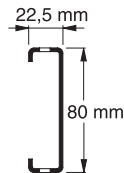

Z1111/Z1371

Size cm	Item No.	Finish	Quantity per VE
H			
200 ¹⁾	290483	①	
220 ²⁾	290485	①	
240 ³⁾	290487	①	

¹⁾ suitable for upright height 200 cm
²⁾ suitable for upright height 220 cm
³⁾ suitable for upright height 240 cm

Fixing parts CG 55x40, begin

for screw-on section 80x22.5 mm. For 1 screw-on section (contains 5 screws)

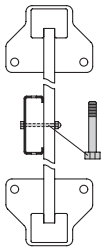

Z1585

	290430	37	

Fixing parts CG 55x40, continuation

for screw-on section 80x22.5 mm. For 2 screw-on sections (contains 5 screws)

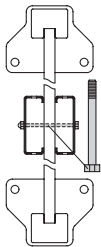

Z1586

	290431	37	

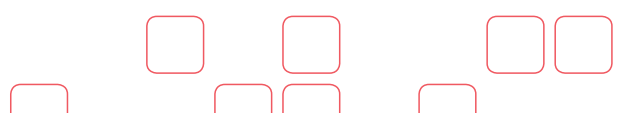

A Stands

Unscrewed stand, CG 70×80

made of C-profile 70×80 mm (screws included).
Not assembled



Z3667

Screw-on section 80×26.5 mm

with foot disk, suitable for stand CG 70×80 with stand height 220 cm, for integration in front

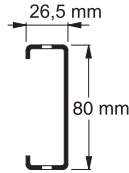

Z1092/Z1372

Screw-on section 80×26.5 mm

with foot disk, suitable for stand CG 70×80 with stand heights 200 cm, 220 cm and 240 cm, for integration in front

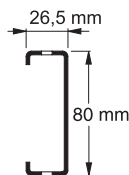

Z1092/Z1372

Size cm		Item No.	Finish	Quantity per VE
T	H			
85 ¹⁾	220	298206	①	51
85 ¹⁾	280	298226	①	51
85 ¹⁾	360	298253	①	51
85 ¹⁾	440	298280	①	51
85 ¹⁾	510	298303	①	51
105 ²⁾	220	298207	①	51
105 ²⁾	280	298227	①	51
105 ²⁾	360	298254	①	51
105 ²⁾	440	298281	①	51
105 ²⁾	510	298304	①	51
115 ³⁾	220	298208	①	51
115 ³⁾	280	298228	①	51
115 ³⁾	360	298255	①	51
115 ³⁾	440	298282	①	51
115 ³⁾	510	298305	①	51

¹⁾ for integrated single bearer for baseleg T 67

²⁾ for integrated single bearer for baseleg T 87

³⁾ for integrated single bearer for baseleg T 97

H				
215 ¹⁾		290422	①	

¹⁾ suitable for stand height 220 cm

H				
200 ¹⁾		290442	①	
220 ²⁾		290444	①	
240 ³⁾		290446	①	

¹⁾ suitable for upright height 200 cm

²⁾ suitable for upright height 220 cm

³⁾ suitable for upright height 240 cm

A Stands

Fixing parts CG 70×80, begin
for screw-on section 80x26.5 mm. For 1 screw-on section (contains 5 screws)

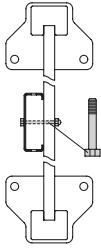

Z1585

Fixing parts CG 70×80, continuation
for screw-on section 80x26.5 mm. For 2 screw-on sections (contains 5 screws)

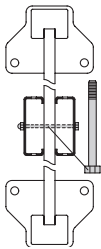

Z1586

Size cm	Item No.	Finish	Quantity per VE
	290433	37	
	290434	37	

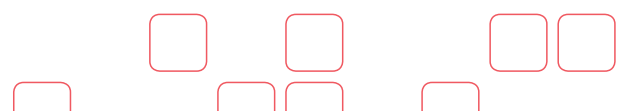

B Traverses

Traverses for TegoTwo-in-One

Traverse top ITDL 80x40

Profile 80x40 mm, with lift-out preventer

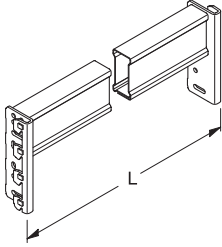

Z4057/Z4060

Size cm

Item No.

Finish

Quantity per VE

L				
125			222243	①
133			222245	①
200			222253	①
250			222260	①
266			222262	①

Traverse centre ITDL 80x40

Profile 80x40 mm, with lift-out preventer

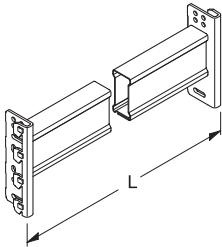

Z4058/Z4061

L				
125			222203	①
133			222205	①
200			222213	①
250			222220	①
266			222222	①

Traverse bottom ITDL 80x40

Profile 80x40 mm, with lift-out preventer

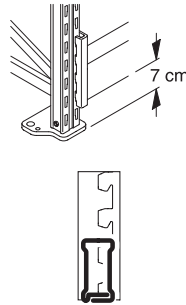
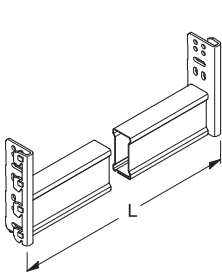

Z4056/Z4076/Z4059

L				
125			222283	①
133			222285	①
200			222293	①
250			222300	①
266			222302	①

Traverse top ITDL 100x40

Profile 100x40 mm, with lift-out preventer

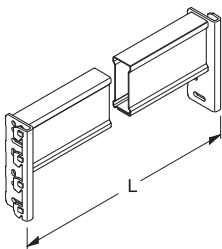

Z4069/Z4072

L				
125			222363	①
133			222365	①
200			222373	①
250			222380	①
266			222382	①

B

B Traverses

Traverse centre ITDL 100×40

Profile 100×40 mm, with lift-out preventer

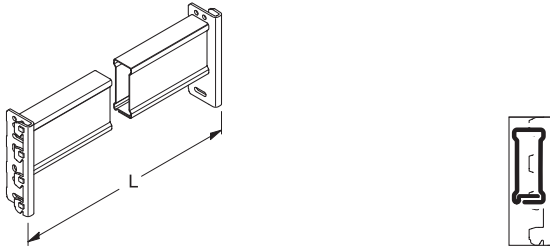

Z4070/Z4073

Size cm	Item No.	Finish	Quantity per VE
L			
125	222323	①	
133	222325	①	
200	222333	①	
250	222340	①	
266	222342	①	

Traverse bottom ITDL 100×40

Profile 100×40 mm, with lift-out preventer

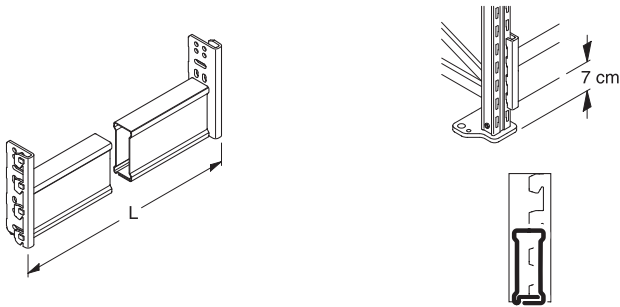

Z4068/Z4076/Z4071

Size cm	Item No.	Finish	Quantity per VE
L			
125	222403	①	
133	222405	①	
200	222413	①	
250	222420	①	
266	222422	①	

Traverse top ITDL 120×40

Profile 120×40 mm, with lift-out preventer

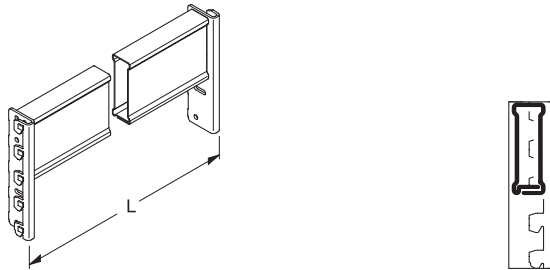

Z4063/Z4066

Size cm	Item No.	Finish	Quantity per VE
L			
125	222483	①	
133	222485	①	
200	222493	①	
250	222500	①	
266	222502	①	
300	222506	①	

Traverse centre ITDL 120×40

Profile 120×40 mm, with lift-out preventer

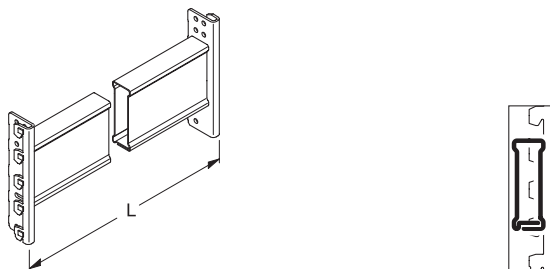

Z4064/Z4067

Size cm	Item No.	Finish	Quantity per VE
L			
125	222443	①	
133	222445	①	
200	222453	①	
250	222460	①	
266	222462	①	
300	222466	①	

B Traverses

Traverse bottom ITDL 120x40
Profile 120x40 mm, with lift-out preventer

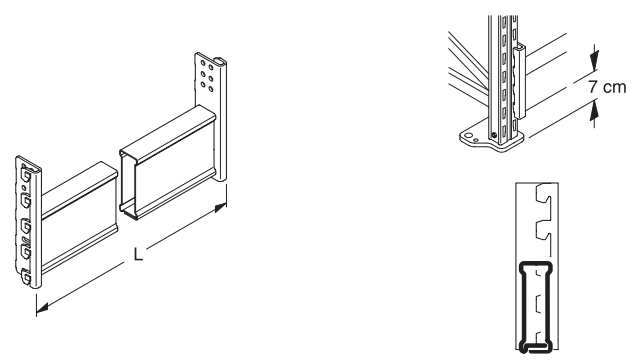

Z4062/Z4076/Z4065

Size cm	Item No.	Finish	Quantity per VE
L			
125	222523	①	
133	222525	①	
200	222533	①	
250	222540	①	
266	222542	①	
300	222546	①	

Traverse top ITDL 130x40
Profile 130x40 mm, with lift-out preventer

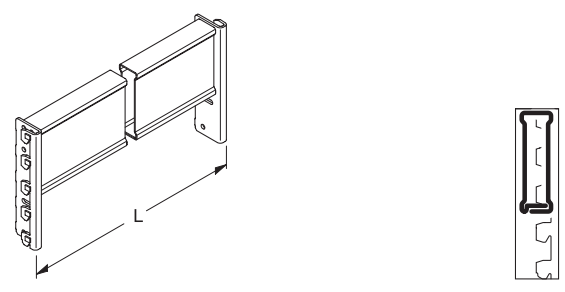

Z4275/Z4276

Size cm	Item No.	Finish	Quantity per VE
L			
125	223433	①	
133	223435	①	
200	223443	①	
250	223450	①	
266	223452	①	
300	223456	①	

Traverse centre ITDL 130x40
Profile 130x40 mm, with lift-out preventer

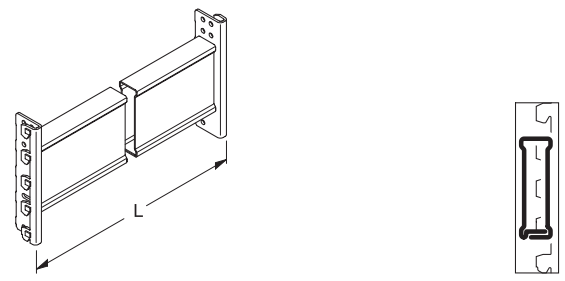

Z4277/Z4278

Size cm	Item No.	Finish	Quantity per VE
L			
125	223393	①	
133	223395	①	
200	223403	①	
250	223410	①	
266	223412	①	
300	223416	①	

Traverse bottom ITDL 130x40
Profile 130x40 mm, with lift-out preventer

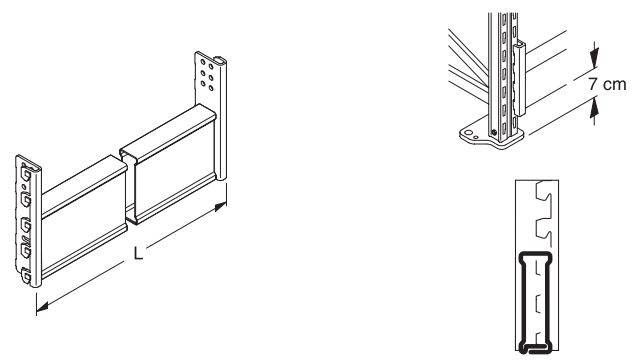

Z4279/Z4076/Z4280

Size cm	Item No.	Finish	Quantity per VE
L			
125	223473	①	
133	223475	①	
200	223483	①	
250	223490	①	
266	223492	①	
300	223496	①	

B

B Traverses

Traverse top ARPL 60x40

ARP profile 60x40 mm, with lift-out preventer; for fitting perforated ARP shelves, shelving elements ARP and chipboards 22 mm.

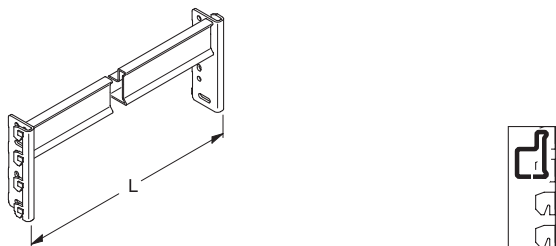

Z1774/Z1790

Size cm	Item No.	Finish	Quantity per VE
L			
125	292064	①	
133	292066	①	
200	292073	①	
250	292078	①	
266	292080	①	

Traverse centre ARPL 60x40

ARP profile 60x40 mm, with lift-out preventer; for fitting perforated ARP shelves, shelving elements ARP and chipboards 22 mm.

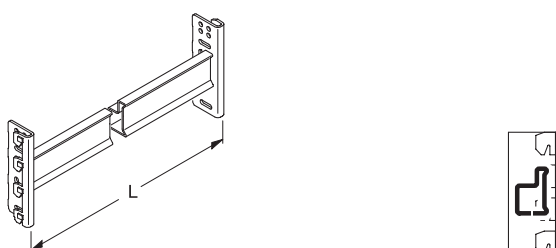

Z1775/Z1791

Size cm	Item No.	Finish	Quantity per VE
L			
125	292034	①	
133	292036	①	
200	292043	①	
250	292048	①	
266	292050	①	

Traverse bottom ARPL 60x40

ARP profile 60x40 mm, with lift-out preventer; for fitting perforated ARP shelves, shelving elements ARP and chipboards 22 mm.

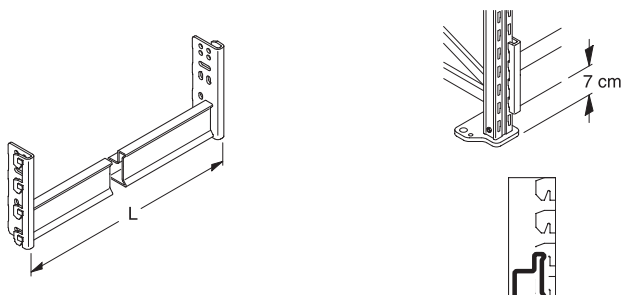

Z1776/Z4076/Z1792

Size cm	Item No.	Finish	Quantity per VE
L			
125	292004	①	
133	292006	①	
200	292013	①	
250	292018	①	
266	292020	①	

Traverse top ARPL 80x40

ARP profile 80x40 mm, with lift-out preventer; for fitting perforated ARP shelves, shelving elements ARP and chipboards 22 mm.

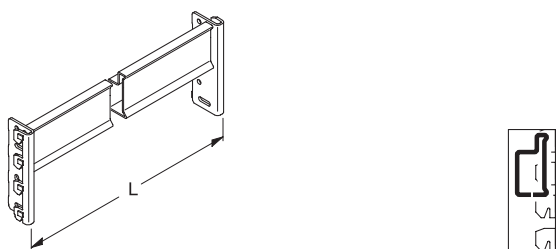

Z1777/Z1793

Size cm	Item No.	Finish	Quantity per VE
L			
125	292154	①	
133	292156	①	
200	292163	①	
250	292168	①	
266	292170	①	

B Traverses

Traverse centre ARPL 80x40

ARP profile 80x40 mm, with lift-out preventer; for fitting perforated ARP shelves, shelving elements ARP and chipboards 22 mm.

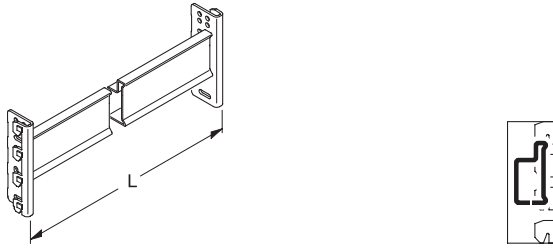

Z1778/Z1794

Size cm	Item No.	Finish	Quantity per VE
L			
125	292124	①	
133	292126	①	
200	292133	①	
250	292138	①	
266	292140	①	

Traverse bottom ARPL 80x40

ARP profile 80x40 mm, with lift-out preventer; for fitting perforated ARP shelves, shelving elements ARP and chipboards 22 mm.

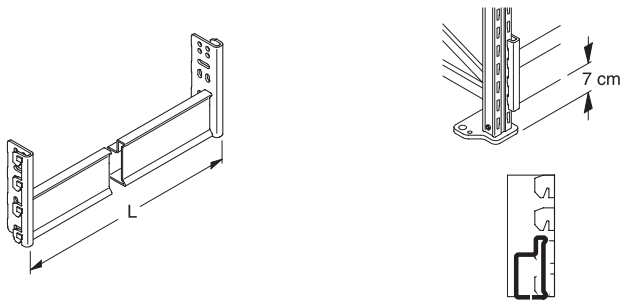

Z1779/Z4076/Z1795

Size cm	Item No.	Finish	Quantity per VE
L			
125	292094	①	
133	292096	①	
200	292103	①	
250	292108	①	
266	292110	①	

Traverse centre / top ARPL 60x40 T6

ARP profile 60x40 mm, with lift-out preventer; for fitting perforated ARP shelves, shelving elements ARP and chipboards 22 mm.

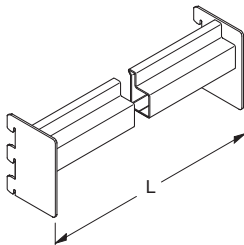

Z3671

Size cm	Item No.	Finish	Quantity per VE
L			
125	292362	①	
133	292363	①	
200	292365	①	
250	292368	①	
266	292369	①	

C Depth Connectors and Shelving Elements

Depth connectors

FO depth connector recessed

for system CG 55x40; suitable for traverse width 40 mm and for chipboard 19 mm thick.

Note:

Permissible load per FO depth connector recessed with
Depth T 80 and Depth T 115 = 440 kg.

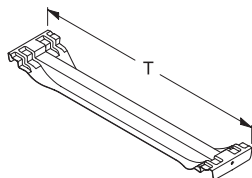

Z4074

FO depth connector

for system CG 70x80; suitable for traverse width 40 mm and 50 mm.

Note:

Permissible load per FO depth connector with

Depth T 80 = 660 kg,

Depth T 85 = 650 kg,

Depth T 105 = 490 kg,

Depth T 115 = 440 kg.

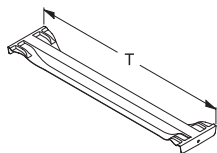

Z3974

FO depth connector recessed

for system CG 70x80; suitable for traverse width 40 mm and for chipboard 22 mm thick.

Note:

Permissible load per FO depth connector recessed with

Depth T 85 = 440 kg,

Depth T 105 = 440 kg,

Depth T 115 = 440 kg.

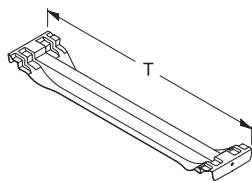

Z4074

Size cm	Item No.	Finish	Quantity per VE
T			
80	229150	51	
115	229151	51	
T			
80	229120	51	
85	229121	51	
105	229122	51	
115	229123	51	
T			
85	229140	51	
105	229141	51	
115	229142	51	



C Depth Connectors and Shelving Elements

Size cm

Item No.

Finish

Quantity per VE

Shelving elements

Shelving elements ARP

for System CG 55x40. Sheet steel, for insertion in traverse ARP. (Suitable for traverse ARP 60x40 and ARP 80x40)

51 = zinc galvanized

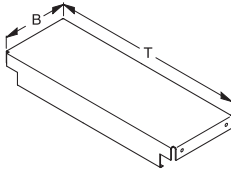

Z1786

T	B			
53 ¹⁾	18.7	207000	①	51
53 ¹⁾	22.6	207010	①	51
63 ²⁾	18.7	207001	①	51
63 ²⁾	22.6	207011	①	51
73 ³⁾	18.7	207002	①	51
73 ³⁾	22.6	207012	①	51
90 ⁴⁾	18.7	207003	①	51
90 ⁴⁾	22.6	207013	①	51
110 ⁵⁾	18.7	207004	①	51
110 ⁵⁾	22.6	207014	①	51
130 ⁶⁾	18.7	207005	①	51
130 ⁶⁾	22.6	207015	①	51
150 ⁷⁾	18.7	207006	①	51
150 ⁷⁾	22.6	207016	①	51

¹⁾ T 53 for stand depth 60

²⁾ T 63 for stand depth 70

³⁾ T 73 for stand depth 80

⁴⁾ T 90 for stand depth 95

⁵⁾ T 110 for stand depth 115

⁶⁾ T 130 for stand depth 135

⁷⁾ T 150 for stand depth 155

Shelving elements ARP

for System CG 70x80. Sheet steel, for insertion in traverse ARP. (Suitable for traverse ARP 60x40 and ARP 80x40)

51 = zinc galvanized

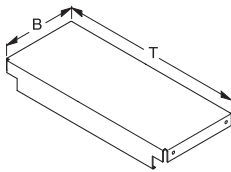

Z1787

T	B			
82 ¹⁾	18.7	207020	①	51
82 ¹⁾	22.6	207025	①	51
102 ²⁾	18.7	207021	①	51
102 ²⁾	22.6	207026	①	51
112 ³⁾	18.7	207022	①	51
112 ³⁾	22.6	207027	①	51

¹⁾ T 82 for stand depth 85

²⁾ T 102 for stand depth 105

³⁾ T 112 for stand depth 115

Perforated ARP shelf

for systems CG 55x40. Steel shelf galvanized, perforated. For insertion in traverse ARP. (Suitable for traverse ARP 60x40 and ARP 80x40)

51 = zinc galvanized

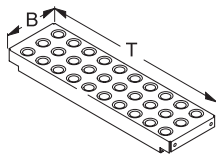

Z3668

T	B			
53 ¹⁾	18.7	207030	①	51
53 ¹⁾	22.6	207040	①	51
63 ²⁾	18.7	207031	①	51
63 ²⁾	22.6	207041	①	51
73 ³⁾	18.7	207032	①	51
73 ³⁾	22.6	207042	①	51
90 ⁴⁾	18.7	207033	①	51
90 ⁴⁾	22.6	207043	①	51
110 ⁵⁾	18.7	207034	①	51
110 ⁵⁾	22.6	207044	①	51
130 ⁶⁾	18.7	207035	①	51
130 ⁶⁾	22.6	207045	①	51

¹⁾ T 53 for stand depth 60

²⁾ T 63 for stand depth 70

³⁾ T 73 for stand depth 80

⁴⁾ T 90 for stand depth 95

⁵⁾ T 110 for stand depth 115

⁶⁾ T 130 for stand depth 135

C Depth Connectors and Shelving Elements

Perforated ARP shelf

for systems CG 70x80. Steel shelf galvanized, perforated. For insertion in traverse ARP.
(Suitable for traverse ARP 60x40 and ARP 80x40)

51 = zinc galvanized

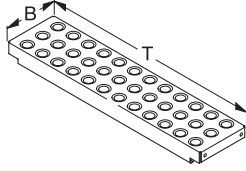

Z3669

Size cm		Item No.	Finish	Quantity per VE
T	B			
82 ¹⁾	18.7	207050	51	
82 ¹⁾	22.6	207055	51	
102 ²⁾	18.7	207051	51	
102 ²⁾	22.6	207056	51	
112 ³⁾	18.7	207052	51	
112 ³⁾	22.6	207057	51	

¹⁾ T 82 for stand depth 85

²⁾ T 102 for stand depth 105

³⁾ T 112 for stand depth 115



D Accessories and Safeguard Parts

Accessories for TegoTwo-in-One

Spacer bracket

for TegoTwo-in-One, with lift-out preventer

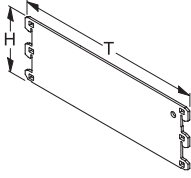

Z0650

Size cm		Item No.	Finish	Quantity per VE
T	H			
10	12	201550	①	
15	12	201552	①	
20	12	201554	①	
30	12	201558	①	
40	12	201562	①	

Spacer bracket, recessed

for TegoTwo-in-One, with lift-out preventer; for subsequent detachment and suspension

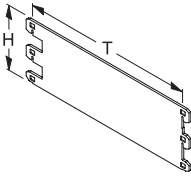

Z0651

Size cm		Item No.	Finish	Quantity per VE
T	H			
10	12	201510	①	
15	12	201512	①	
20	12	201514	①	
30	12	201516	①	
40	12	201518	①	

Sheet metal underlay

for stand CG 55x40, for compensation of floor unevenness

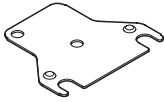

Z0917

Size cm	Item No.	Finish	Quantity per VE
H			
0.15	206410		51
0.20	206412		51
0.60	206414		88

Sheet metal underlay

for stand CG 70x80, for compensation of floor unevenness

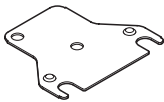

Z0917

Size cm	Item No.	Finish	Quantity per VE
H			
0.15	200250		51
0.20	200252		51
0.60	200254		88

Top cap for CG 55x40

Sheet steel



Z0932

Item No.	Finish	Quantity per VE
293400		①

Top cap for CG 70x80

Sheet steel

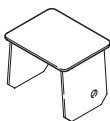

Z0957

Item No.	Finish	Quantity per VE
201889		①

D Accessories and Safeguard Parts

Safety accessories for TegoTwo-in-One

Tow bow

for stand CG 55x40. Tubular steel with fastening screws

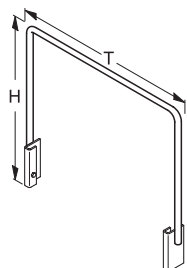

Z0657

Size cm		Item No.	Finish	Quantity per VE
T	H			
60	50	290462	①	
70	50	290463	①	
80	50	290460	①	
95	50	290464	①	
115	50	290461	①	

Tow bow

for stand CG 70x80. Tubular steel with fastening screws

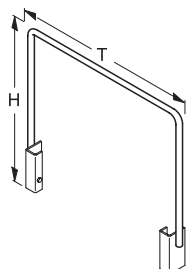

Z0658

T	H			
85	50	290554	①	
105	50	290556	①	
115	50	290551	①	

Push-through guard T 4

for TegoTwo-in-One, profile 50x20

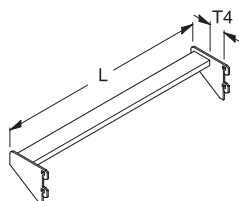

Z3675

L				
125		204404	①	
133		204406	①	
200		204413	①	
250		204418	①	
266		204420	①	

Back grating H 100

for TegoTwo-in-One, mesh size approx. 50x50 mm, wire diameter 3 mm

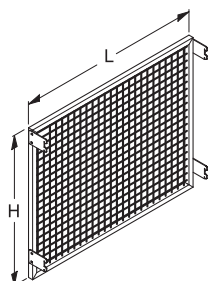

Z0661

L	T	H			
125	12	100	205100	①	
133	12	100	205102	①	
200	12	100	205104	①	
250	12	100	205106	①	
266	12	100	205108	①	



D Accessories and Safeguard Parts

Bumper (corner)

for fastening TegoTwo-in-One stands on the floor
(Yellow / Black)

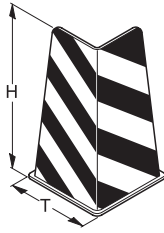

Z0664

Rigid fixation accessories

for bumper (corner)

Load distribution shoe CG 55x40

Sheet steel, to reduce the specific floor load on soft floors, for stand CG 55x40

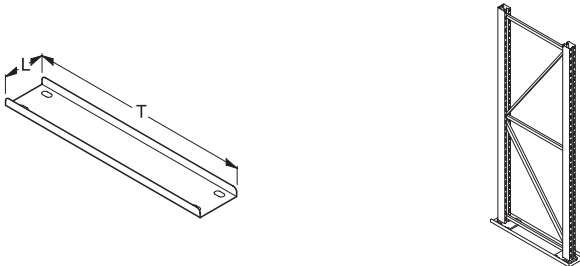

Z0665 / Z0666

Load distribution shoe CG 70x80

Sheet steel, to reduce the specific floor load on soft floors, for stand CG 70x80

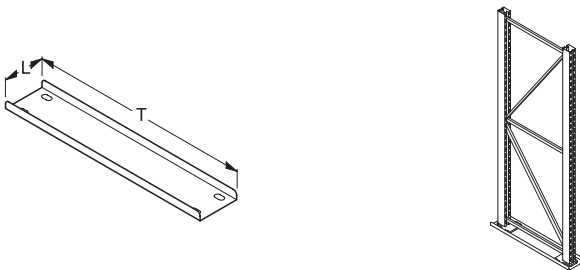

Z0665 / Z0666

Load sign DIN A4 Yellow

Important note: The load limits must be clearly marked by means of load signs on all TegoTwo-in-One shelving.
(Figure shows an example sign)

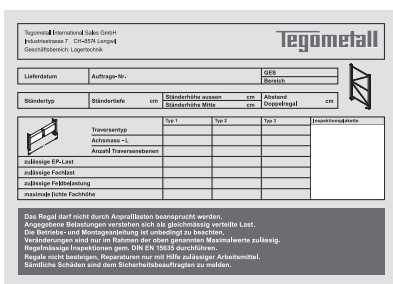

Size cm		Item No.	Finish	Quantity per VE
T	H			
18	40	201530	35	
18	60	201540	35	

			201532	37	
--	--	--	--------	----	--

L	T			
15	60	206682	41	
15	70	206684	41	
15	80	206686	41	
15	95	206690	41	
15	115	206692	41	

L	T			
16	85	201542	41	
16	105	201546	41	
16	115	201548	41	

			200129*	
--	--	--	---------	--

* Note: Please state the required language on ordering.

D Accessories and Safeguard Parts

Load sign

Important note: The load limits must be clearly marked by means of load signs on all TegoTwo-in-One shelving.
(Figure shows an example sign)

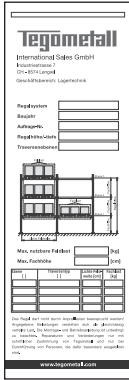

Size cm	Item No.	Finish	Quantity per VE
	31030*		

*** Note:** Please state the required language on ordering.

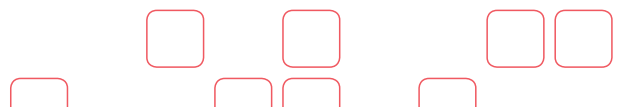

E Parts for Integration

Parts for integration for TegoTwo-in-One

Upright 80×30 mm

H-slots on two sides, for shelving and gondolas

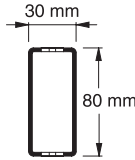

Z0016/Z0017

Size cm	Item No.	Finish	Quantity per VE
H			
180	111019	①	
200	111020	①	
220	111021	①	
240	111765	①	

Baseleg H 16

low version with 2 foot disks, height adjustable

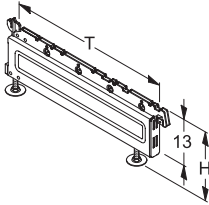

Z4292

T	H	Item No.	Finish	Quantity per VE
37	16	122402	①	
47	16	122404	①	
57	16	122406	①	
67	16	122408	①	

Single bearer (Pair)

for stand CG 55×40. Compatible with baselegs H 16. Sheet steel.

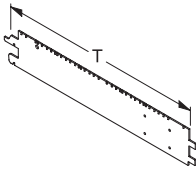

Z0615

T	Item No.	Finish	Quantity per VE
37 ¹⁾	208260	①	
47 ²⁾	208262	①	
57 ³⁾	208264	①	
67 ⁴⁾	208266	①	

¹⁾ Stand T 95, double-sided
³⁾ Stand T 70

²⁾ Stand T 60, stand T 115, double-sided
⁴⁾ Stand T 80

Single bearer (Pair)

for stand CG 55×40. Compatible with shelf brackets. Sheet steel.

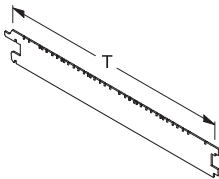

Z0614

T	Item No.	Finish	Quantity per VE
37 ¹⁾	208250	①	
47 ²⁾	208252	①	
57 ³⁾	208254	①	
67 ⁴⁾	208256	①	

¹⁾ Stand T 95, double-sided
³⁾ Stand T 70

²⁾ Stand T 60, stand T 115, double-sided
⁴⁾ Stand T 80

Single bearer (Pair)

for stand CG 70×80. Compatible with baselegs H 16. Sheet steel.

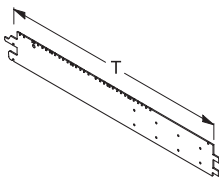

Z0676

T	Item No.	Finish	Quantity per VE
67 ¹⁾	208222	①	
87 ²⁾	208226	①	
97 ³⁾	208228	①	

¹⁾ Stand T 85

²⁾ Stand T 105

³⁾ Stand T 115

TegoClassic Index

A		G		T	
Angular shelf brackets for wooden and glass shelves	34	Grid shelf, close meshed with price ticket holder	55	TEK wire basket	55
B		Grid shelf PBE	56	Tie-bar	26
Back panel clips	39	Grid shelf with front and back groove	55	Tool holder	42,53
Back panel cover strip	39	H		Tool holder for drilling machine	42
Back panel GL, internal corner 45°	36	Holder heavy type	41,43,44	Tool holder, special	42
Back panel GL, internal corner 90°	36	Hook for blister packings	40	Top cap for upright 30x30 mm	27
Back panel GL, internal corner round 45°	36	Hook-on bracket	53	Top cap for upright 60x30 mm	28
Back panel GL, painted on both sides	36	I		Top cap for upright 80x30 mm	28
Back panel GL, painted on one side	36	Insertion hook	50	Top caps for uprights	27
Back panel RL, internal corner 45°	38	L		U	
Back panel RL, internal corner 90°	38	Label jacket	41	Upright 60x30 mm	25
Back panel RL, internal corner round 45°	38	Lift-out preventers for shelf	46	Upright 80x30 mm	25,26
Back panel RL, painted on both sides	37	Lower soffit, shaped	52	Upright 110x30 mm	26
Back panel RL, painted on one side	37	Lower soffit, straight	51	Upright extension 60x30 mm	27
Back panel safeguard	38	Lower soffit, straight, T 20	52	Upright extension 80x30 mm	27
Back panel SL, painted on both sides	37	Low front strip	48	Upright extension 110x30 mm	27
Back panel SL, painted on one side	37	P		Uprights for gondola end frame	54
Back wire grating	56	Panel clip	40	W	
Bar hook with end plate	53	Panel clip for transverse panel	39	Wall fixing brackets for upright, adjustable	30
Base draw unit H 10	33	Plinth	32	Wall fixing brackets for upright, top	29
Base draw unit H 18	33	Plinth end	33	Wall fixing brackets upright	29
Baseleg H 16	31	Plinth, external corner 90°	32	Wall-mount upright	25
Baseleg H 26	31	Plinth, internal corner 45°	32		
Baseleg light-weight H 8	31	Plinth, internal corner 90°	32		
Base shelf support	31	Plinth, internal corner round 45°	32		
Blister hook	41,42,43,53	R			
Border strip H 1	48	Rear support bar 50x20 mm	52		
Border strip H 5	48	Retrofit flag	41		
Bracket for fascia return	51	Ridged rubber mat	46		
Brackets 3 H extra heavy duty	34	S			
Brackets 4 H extra heavy duty	34	Scanning frame	50		
C		Scanning ticket strip H 4	49,50		
Ceiling fixing 30x30 mm	29	Scanning ticket strip H 4 PBE PKE	56		
Ceiling fixing 60x30 mm	29	Scanning ticket strip H 4 TEK	55		
Central panel clips	39	Screw accessories for angular shelf brackets ..	35		
Clothes frame, straight	54	Separator, without plate	52		
Connection bar	35	Separator, with plate	52		
Connection bars for gondola end frame	54	Shelf brackets 2 H	33,34		
D		Shelf brackets 3 H	34		
Divider for TEK wire baskets	55	Single hinged hook	40		
Divider grid	49	Single hook	40		
Divider grid (glossy zinc-plated)	49	Single prong hook with label holder	53		
Divider plain	47	Slat-panel	43		
Divider sheet H 5.5 quadrant	48	Slat-panel internal corner 90°	43		
Divider sheet H 10 quadrant	48	Slat-panel with slit	43		
Divider sheet H 15 quadrant	48	Standard bolt M 5x10 mm	42		
Divider with toothing	47	Steel shelf	45		
Dividing strip	47	Steel shelf, external corner 45°	46		
Double hinged hook	40	Steel shelf, external corner 90°	45		
E		Steel shelf, internal corner 45°	46		
End tap	28	Steel shelf, internal corner 90°	45		
Extension element with foot disk	29	Steel shelf, internal corner round 45°	45		
F		Subdivider	47		
Fascia bracket H 20	51				
Fascia H 20	51				
Fascia return H 20	51				
Filler plate	46				
Foot disk	28				
Foot disk with pin	28				
Front glass	47				
Front grid	49				
Front grid (glossy zinc-plated)	49				

TegoTwo-in-One Index

B

Back grating H 100	82
Baseleg H 16	85
Bumper (corner)	83

F

Fixing parts C 55x40, continuation	70
Fixing parts CG 55x40, begin	70
Fixing parts CG 70x80, begin	72
Fixing parts CG 70x80, continuation	72
FO depth connector	78
FO depth connector recessed	78

L

Load distribution shoe CG 55x40	83
Load distribution shoe CG 70x80	83
Load sign	84
Load sign DIN A4 Yellow	83

P

Perforated ARP shelf	79,80
Push-through guard T 4	82

R

Rigid fixation accessories	83
----------------------------------	----

S

Screw-on section 80x22.5 mm	69,70
Screw-on section 80x26.5 mm	71
Sheet metal underlay	81
Shelving elements ARP	79
Single bearer	85
Spacer bracket	81
Spacer bracket, recessed	81

T

Top cap for CG 55x40	81
Top cap for CG 70x80	81
Tow bow	82
Traverse bottom ARPL 60x40	76
Traverse bottom ARPL 80x40	77
Traverse bottom ITDL 80x40	73
Traverse bottom ITDL 100x40	74
Traverse bottom ITDL 120x40	75
Traverse bottom ITDL 130x40	75
Traverse centre ARPL 60x40	76
Traverse centre ARPL 80x40	77
Traverse centre ITDL 80x40	73
Traverse centre ITDL 100x40	74
Traverse centre ITDL 120x40	74
Traverse centre ITDL 130x40	75
Traverse centre / top ARPL 60x40 T6	77
Traverse top ARPL 60x40	76
Traverse top ARPL 80x40	76
Traverse top ITDL 80x40	73
Traverse top ITDL 100x40	73
Traverse top ITDL 120x40	74
Traverse top ITDL 130x40	75

U

Unscrewed stand, CG 55x40	69
Unscrewed stand, CG 55x40 for integration on both sides	69
Unscrewed stand, CG 70x80	71
Upright 80x30 mm	85

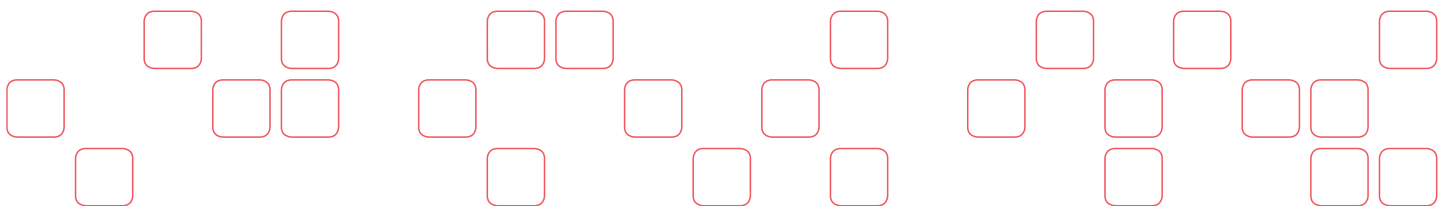

Notes

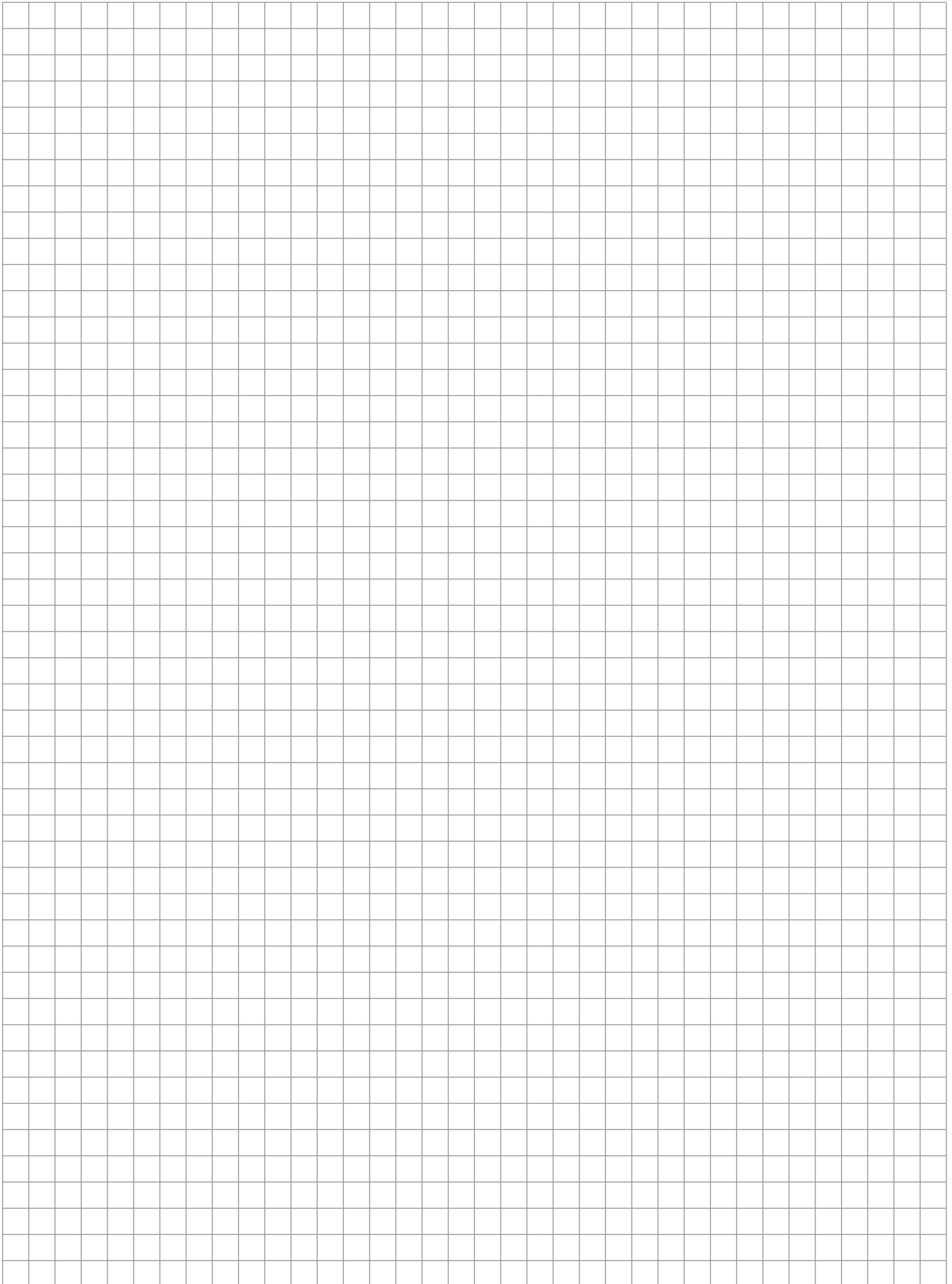

Head office in Switzerland

Tegometall International Sales GmbH
Industriestrasse 7
8574 Lengwil
Switzerland

Telephone: +41 71 686 93 00

info@tegometall.com
www.tegometall.com

Sales location in Slovenia

Tegometall inženiring d.o.o.
Cesta Kozjanskega odreda 29
3230 Šentjur
Slovenia

Telephone: +3863 746 32 44

info@tegometall-inzeniring.com
www.tegometall.com

Sales location in Great Britain

Tegometall UK Sales Limited
Tegometall House / 10 Meadowbank Way
Eastwood / Nottinghamshire / NG16 3SB
Great Britain

Telephone: +44 1773 711 322

info@tegometall.co.uk
www.tegometall.com

Sales location in France

Tegometall France S.A.R.L
Eurozone Forbach Nord
1 rue Jules Verne
57600 Forbach
France

Telephone: +33 3 87 88 87 70

info@tegometall.fr
www.tegometall.com

Sales location in Poland

Tegometall Wyposażenie Sklepów Pniewy Sp. z o.o.
ul. Konińska 26
62-045 Pniewy
Poland

Telephone: +48 61 29 10 597

wsp@tegometall.com
www.tegometall.com

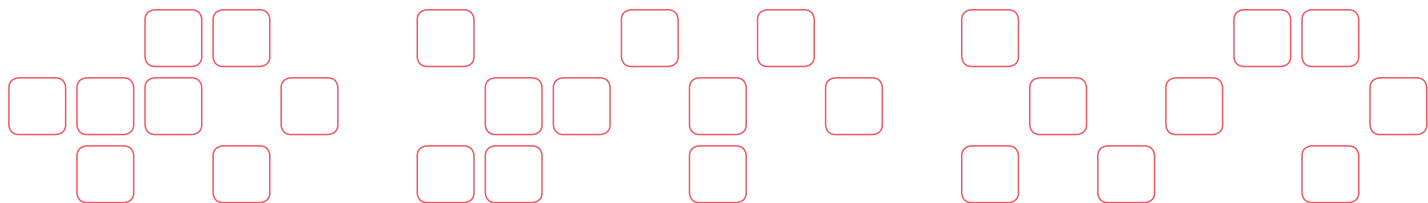

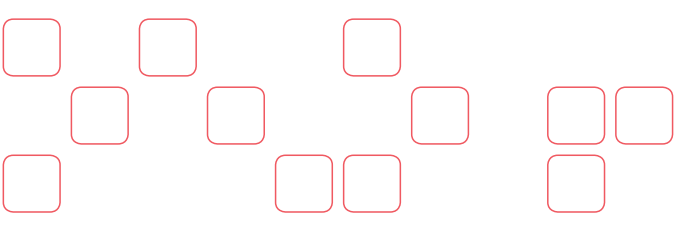

OUR ORIGINAL. YOUR SUCCESS.